

LEFT SIDE VIEW

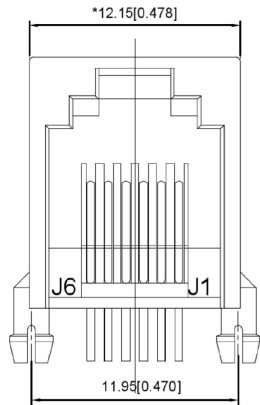

FRONT VIEW

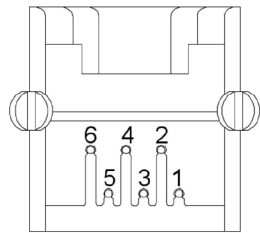

BOTTOM VIEW

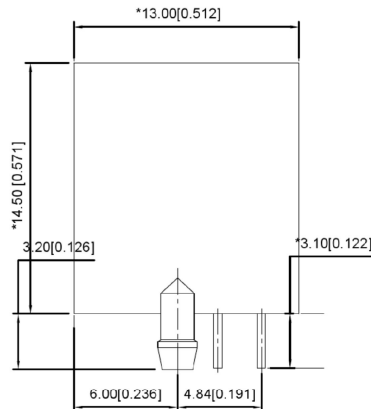

RIGHT SIDE VIEW

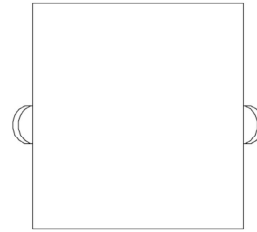

TOP VIEW

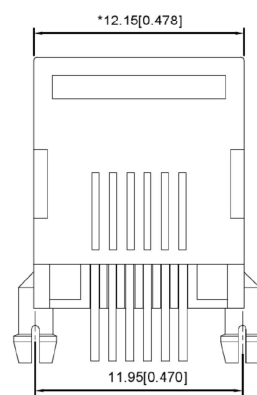

BACK VIEW

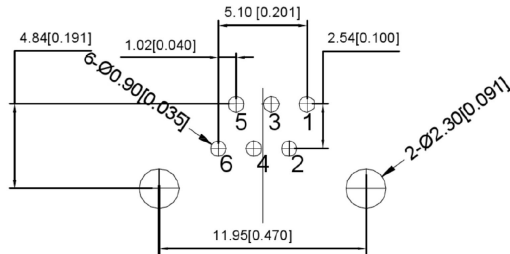

RECOMMENDED PCB LAYOUT  
VIEWED FROM COMPONENT SIDE

MATERIAL 材料:  
 HOUSING 外壳: PBT,UL94V-0,BLACK.  
 TERMINAL 端子: PHOSPHOR BRONZE Ø=0.46MM, GOLD PLATING  
 MECHANICAL 机械:  
 DURABILITY 耐用性: 750 CYCLES MIN,12.5MM/MINUTE.  
 INSERTION FORCE 插入力:2.2KG.F MAX  
 RETENTION STRENGTH 保持力:7.7KG.F BETWEEN JACK AND PLUG.  
 OPERATING TEMPERATURE 工作温度: -40°C~+85°C.  
 STORAGE TEMPERATURE 储存温度: -40°C~+85°C.  
 ALL CRITICAL DIMENSIONS WITH "\*"

ELECTRICAL 电气:  
 VOLTAGE 电压: 125 VOLTS AC.  
 CURRENT RATING 电流额定值: 1.5AMP.  
 DIELECTRIC STRENGTH 介电强度: 1000 VAC RMS 50HZ OR 60HZ,1 MIN  
 INSULATION RESISTANCE 绝缘电阻: 500 MEGA OHMS MIN.INITIAL  
 AFTER 500V DC FOR 1 MINUTE.  
 CONTACT RESISTANCE 接触电阻:SINGLE TERMINAL 30 MILLIOHMS MAX.  
 INITIAL 50 MILLIOHMS MAX. AFTER  
 DURABILITY TEST.



				ANGULAR	±5°
				L ≤ 4	±0.2
				4 < L ≤ 16	±0.3
				16 < L ≤ 63	±0.4
				L > 63	±0.5
REVISIONS				UNSPECIFIED TOLERANCES	
www.alpsr.com www.gdxjdz.com www.xbswitch.com					



DSND	SCALE: N/A	MODEL TYPE: RJ JACK
DWN	VIEW:	PART NO.:
CHKD	UNIT: mm/in	DWG NO.:
APPD	SIZE: A4	X09AHIWA1DY4017
		WEIGHT
		SHEET
		REVISION
		1/1
		A0