

Scrolls (S)

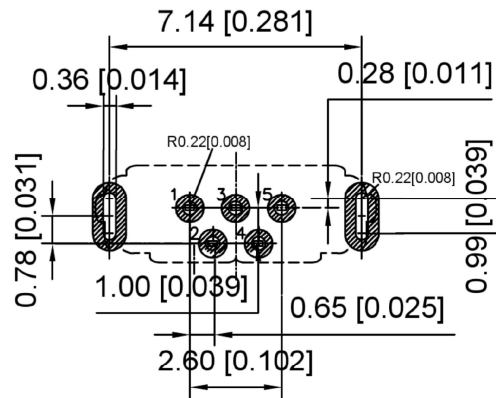

RECOMMENDED P.C.B LAYOUT

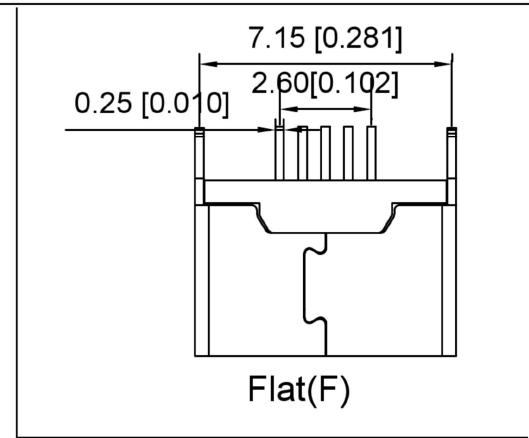

Flat(F)

Material
 Housing Material: LCP, UL94V-0, black
 Contact Terminal: Copper Alloy
 Metallic Shell: Sus
 Electrical
 Voltage Rating: 30 V AC
 Current Rating: Signal (Pins 2,3,4): 1.0A, Power (Pins 1,5): 1.8A
 Contact Resistance: 30mΩ Max
 Insulation resistance: 1000MΩ Min
 Dielectric withstanding voltage: 250V AC/Minute
 Mechanical
 Durability: 10,000 cycles
 Mating Force: 35N (3.57Kgf) Max
 Unmating Force: 8N (0.82Kgf) Min.

U255-05XX-4BH70-X-S
 1:AU 1U"
 6:AU 30U"
 T:TIN
 N:NICKEL
 S:Sus
 S:Scrolls F:Flat
 B:BLACK W:WHITE
 1:PBT
 2:PA6T
 3:PA9T
 4:LCP

				ANGLAR	±5°
				L ≤ 4	±0.2
				4 < L ≤ 16	±0.3
				16 < L ≤ 63	±0.4
				L > 63	±0.5
REVISIONS				UNSPECIFIED TOLERANCES	
	DATE	REVISED	APPROVED		
www.alpsr.com www.gdxjdz.com www.xbswitch.com					

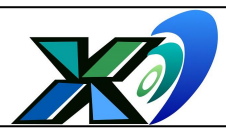

DSND	SCALE: N/A	MODEL TYPE: MICRO USB
DWN	VIEW:	PART NO.:
CHKD	UNIT: mm/in	DWG NO.:
APPD	SIZE: A4	U255-05XX-4BH70-XS
		WEIGHT
		SHEET
		REVISION
		1/1
		A0

DONG GUAN XI BANG ELECTRONIC CO., LTD