

REV.	ECN. NO.	APPD.

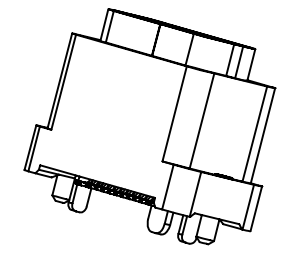
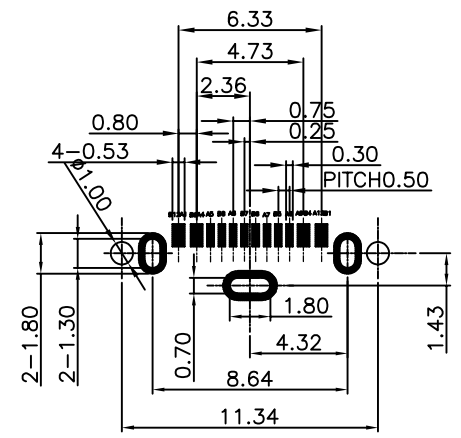
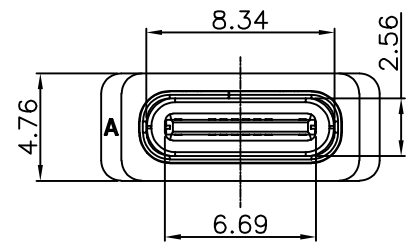

NOTES:
SPECIFICATION:

- CURRENT RATING: 3.0A MAX
- DIELECTRIC WITHSTAND VOLTAGE: 100VAC
- TEMPERATURE RANGE: -30 °C ~ 85 °C
- CONTACT RESISTANCE: 40 MILLIONHM MAX
- INSULATION RESISTANCE: 100 MEGOHMS MIN.
- INSERTION FORCE : 5N~20N
- UNMATING FORCE: 8N~20N
- DURABILITY:10,000 CYCLES

RECOMMENDED PCB LAYOUT(TOP VIEW)
(GENERAL TOLERANCE±0.05)

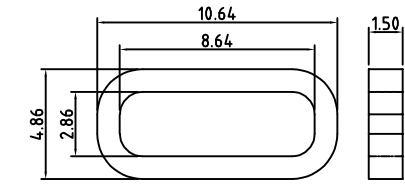
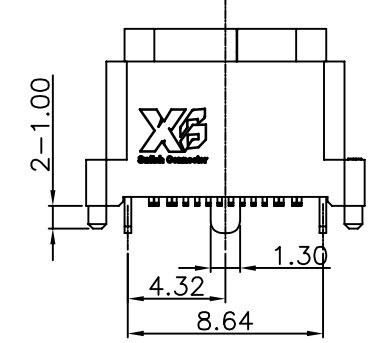
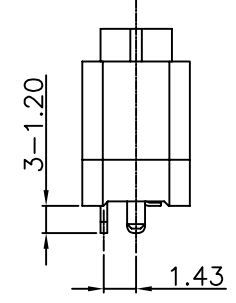
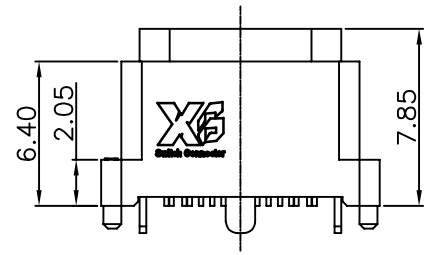

建议胶圈尺寸

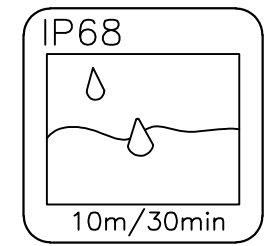
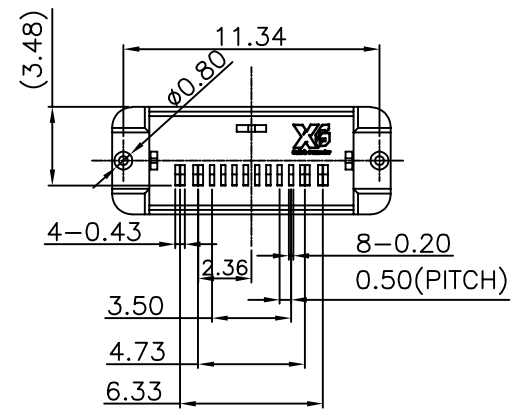

6	防水圈	硅胶	BLACK	1PCS
5	SHELL	STAINLESS STEEL	NI Plated	1PCS
4	SHIELDING PLATE	STAINLESS STEEL	NI Plated	1PCS
3	CONTACT	COPPER ALLOY	Au/Ni Plated	1SET
2	SHELL HOUSING	HIGH TEMPERATURE PLASTIC	BLACK	1PCS
1	HOUSING	HIGH TEMPERATURE PLASTIC	BLACK	1PCS
NO.	DESCRIPTION	MATERIAL	REMARKS	QTY

A1	GND	B12	GND
A4	VBUS	B9	VBUS
A5	CC1	B8	SBU2
A6	DP1	B7	DN2
A7	DN1	B6	DP2
A8	SBU1	B5	CC2
A9	VBUS	B4	VBUS
A12	GND	B1	GND
PIN	SIGNAL NAME	PIN	SIGNAL NAME

X.	± 0.50	X.°	± 2°
.X	± 0.30	.X°	± 1°
.XX	± 0.20	.XX°	± 0.5°
.XXX	± 0.05		

UNITS: mm

MAT'L: /

FINISH: /

Q'TY: /

XIB 东莞市溪榜电子有限公司
DONG GUAN XI BANG ELECTRONICS CO., LTD.

PART NO.: XB-ATCF-0051-IPX8

TITLE: TYPE C 2.0 16Pin 插 SMT Type

APPD: GAO. PENG

CHKD: HE. LONG. FEI

DR: PANG. DONG

DWG NO.: XB-ATCF-0051-IPX8

SCALE: 1/1 1/2

SHEET: 1/1

REV: A2

These drawings and specifications are the property of Dongguan Xi Bang Electronics Co., Ltd. and should not be copied. Copying or using in any way without prior written consent from Dongguan Xi Bang Electronics Co., Ltd