

Notes:

1. Material:

Insulation: Nylon 6 , Color Nature

2. Glow wire requirement:

IEC 60695-2-12 GWFI 960°C@0.38mm & 930°C@0.75mm
& 960°C@1.50mm & 960°C@3.00mm

IEC 60695-2-13 GWIT 930°C@0.38mm & 930°C@0.75mm
& 825°C@1.50mm & 825°C@3.00mm

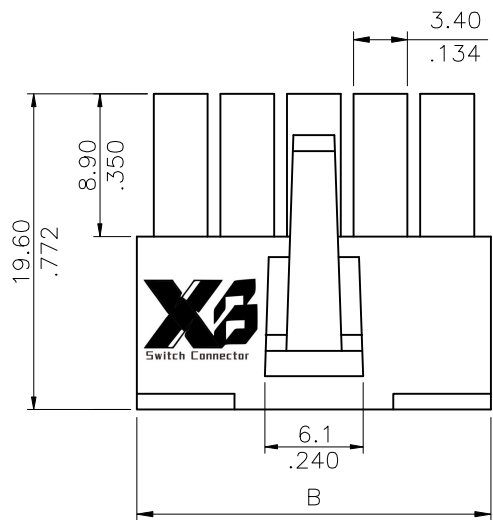

FOR 4 , 5 CIRCUITS

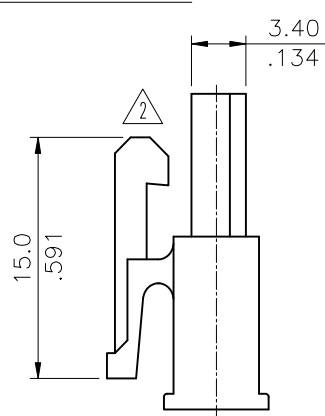

FOR 3 CIRCUITS

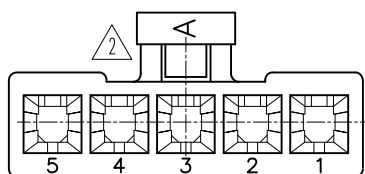
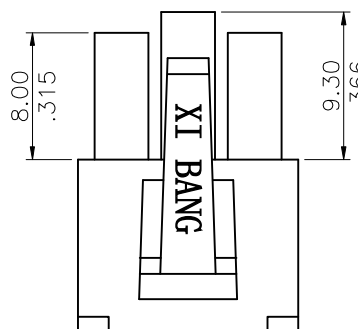

Circuits	Dimension	
	A	B
3	8.40(.331)	13.8(.543)
4	12.60(.496)	18.0(.709)
5	16.80(.661)	22.2(.874)

Ordering Code:

CP-01 1 ** 0 E S
① ② ③ ④ ⑤ ⑥

- ① Series No.
- ② Contact Type: 1= Receptacle
- ③ No of Circuits:
- ④ Plating Code: 0= Non plating
- ⑤ Variation: E= UL 94V-2
(Glow wire available)
- ⑥ Option: S= Single Row

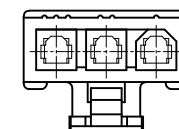

3 CIRCUITS

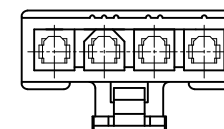

4 CIRCUITS

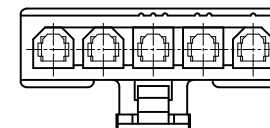

5 CIRCUITS

CIRCUIT PATTERN SCHEDULE

RoHS Compliant

SYM	NAME	DATE	REVISIONS	APPROVED BY:	DATE	UNIT: mm / inch	TITLE:	MATERIAL:	FINISH:	DRAWING NO.	PART NO.	SHEET	OF	1
④					DATE	UNIT: mm / inch	TITLE:							
③					DRAWN BY: Karen	11/12-20'	TOLERANCE	4.20mm PICH RECEPTACLE CONN. (SINGLE ROW)		CP0143AC	CP-011**OES	2 / 1	1	1
②	Karen	11/10-20'	ECNT120261/ECRB120046	ENGINEER: Sun	11/13-20'	UNLESS OTHERWISE SPECIFIED								
①	Kenny	8/27-20'	ECNT120227	CHECKED BY: Eisley	11/18-20'	.X ± 0.38/.015 X' ± 1'								
				APPROVED BY: Eisley	11/18-20'	.XX ± 0.25/.010 .X' ±								
						.XXX ± 0.10/.004 .XX' ±								

XB 东莞市溪榜电子有限公司
Switch Connector DONG GUAN XI BANG ELECTRONI CS CO., LTD.