

Material:

- \* Insulation: Nylon 66 94V-0, Nature Color
- △\* Contact: Phosphor Bronze

Note:

- \* For Tin-Lead Wave Flow Process
- \* Terminal direction is not controlled

Ordering Code:

CP08 \*\* P 1 V D P  
 ① ② ③ ④ ⑤ ⑥ ⑦

- ① Series No.
- ② No. of Circuits: 06,09,12,15
- ③ Contact type: P = Plug
- ④ Contact plated:  
1 = Tin over Nickel
- ⑤ V= Straight
- ⑥ Material: D= Nylon 66, UL 94V-0 (Triple Row)
- ⑦ Other options:  
P= Male Pin, With Peg  
P-N= Male Pin, Without Peg

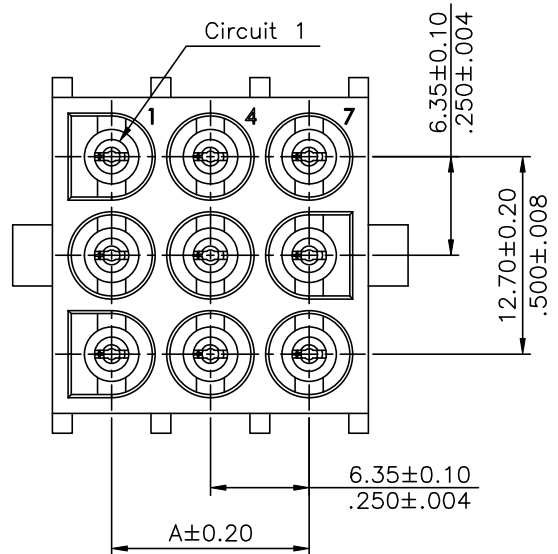

Circuits	Dimensions	
	A	B
06	6.35(.250)	13.97(.550)
09	12.70(.500)	20.32(.800)
12	19.05(.750)	26.67(1.050)
15	25.40(1.000)	33.02(1.300)

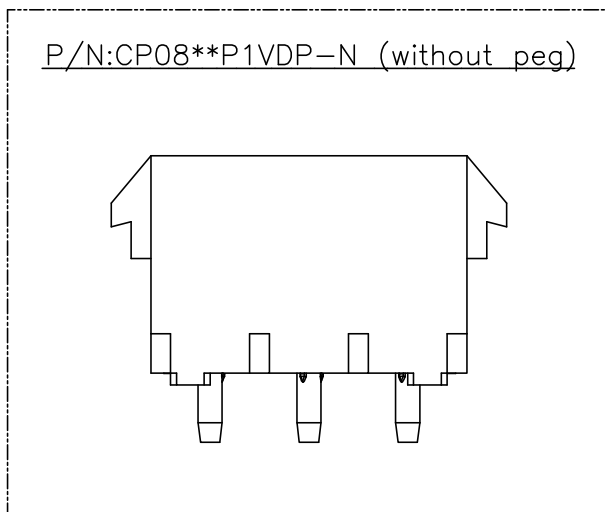
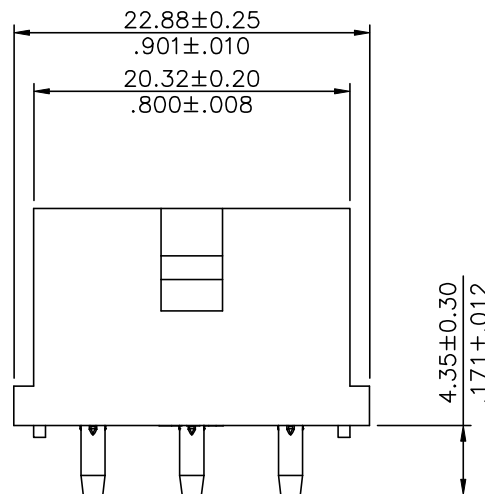
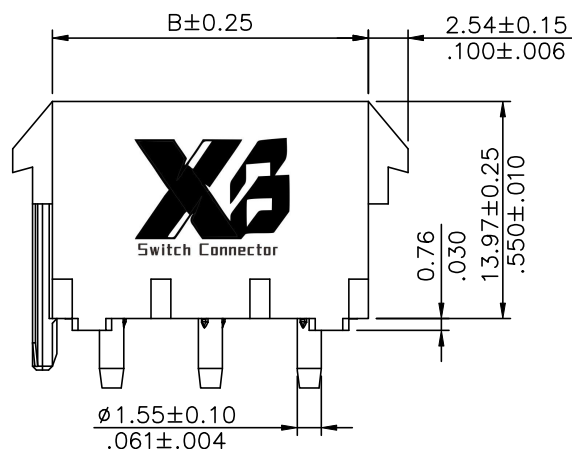

Tin-Lead Process      RoHS Compliant

④					DATE	UNIT: mm / inch	TITLE: 6.35mm PITCH STRAIGHT HEADER POWER CONNECTOR
③				DRAWN BY: Eric	3/8-24'	TOLERANCE UNLESS OTHERWISE SPECIFIED	MATERIAL:
②				ENGINEER: Eric	3/8-24'	.X ± 0.30/.012    .X' ± 1'	
①	Eric	3/8-24'	ECNT124055	CHECKED BY: Eisley	3/8-24'	.XX ± 0.20/.008    .X' ±	FINISH:
SYM	NAME	DATE	REVISIONS	APPROVED BY: Eisley	3/8-24'	.XXX ± 0.10/.004    .XX' ±	

**X3** 东莞市溪榜电子有限公司  
 Switch Connector DONG GUAN XI BANG ELECTRONICS CO., LTD.

DRAWING NO.	CP0812SB	PART NO.	CP08**P1VDP CP08**P1VDP-N
SCALE	2 / 1	SHEET	1 OF 2

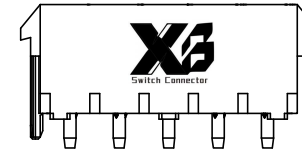
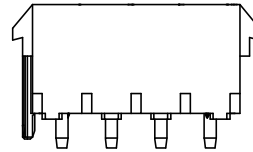
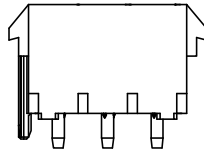
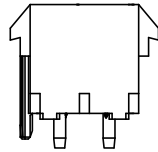
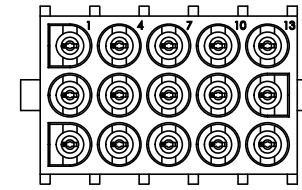
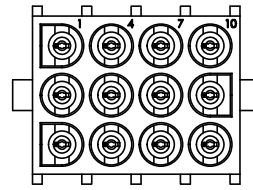
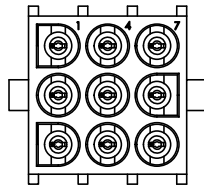
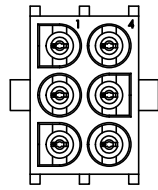

6PIN

9PIN

12PIN

15PIN

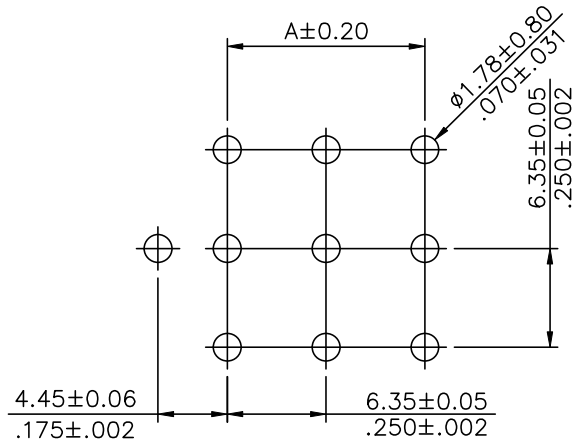

With Peg

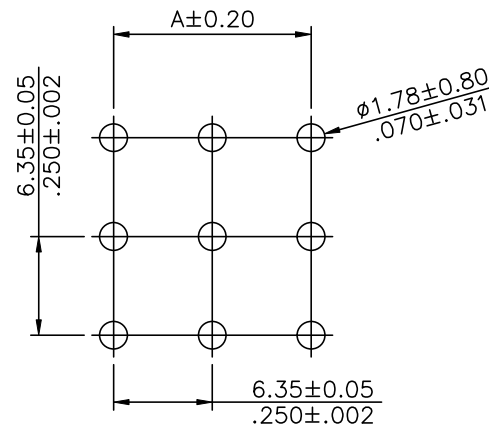

Without Peg

Recommended P.C. Board layout

Circuits	Dimensions
	A
06	6.35(.250)
09	12.70(.500)
12	19.05(.750)
15	25.40(1.000)

Tin-Lead Process      RoHS Compliant

4					DATE	UNIT: mm / inch	TITLE: 6.35mm PITCH STRAIGHT HEADER POWER CONNECTOR
3				DRAWN BY: Eric	3/8-24'	TOLERANCE UNLESS OTHERWISE SPECIFIED	MATERIAL:
2				ENGINEER: Eric	3/8-24'		
1	Eric	3/8-24'	ECNT124055	CHECKED BY: Eisley	3/8-24'	.XX ± 0.20/.008    .X* ±	FINISH:
SYM	NAME	DATE	REVISIONS	APPROVED BY: Eisley	3/8-24'	.XXX ± 0.10/.004    .XX* ±	

**XB** 东莞市溪榜电子有限公司  
Switch Connector DONG GUAN XI BANG ELECTRONICS CO., LTD.

DRAWING NO.	CP0812SB	PART NO.	CP08**P1VDP CP08**P1VDP-N
SCALE	2 / 1	SHEET	2 OF 2