

Material:

\* Insulation: Nylon 66 94V-0, Nature Color

△\* Contact: Phosphor Bronze

Note:

\* For Tin-Lead Wave Flow Process

\* Terminal direction is not controlled

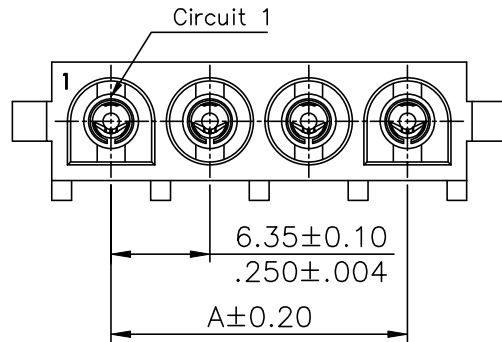

Circuits	Dimension	
	A	B
2	6.35(.250)	13.97(.550)
3	12.70(.500)	20.32(.800)
4	19.05(.750)	26.67(1.050)
5	25.40(1.000)	33.02(1.300)
6	31.75(1.250)	39.37(1.550)
8	44.45(1.750)	52.07(2.050)
10	57.15(2.250)	64.77(2.550)

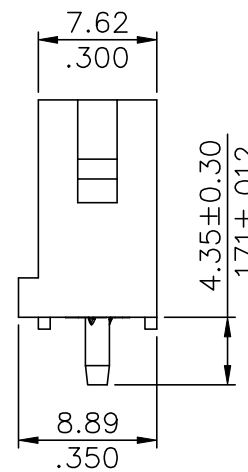
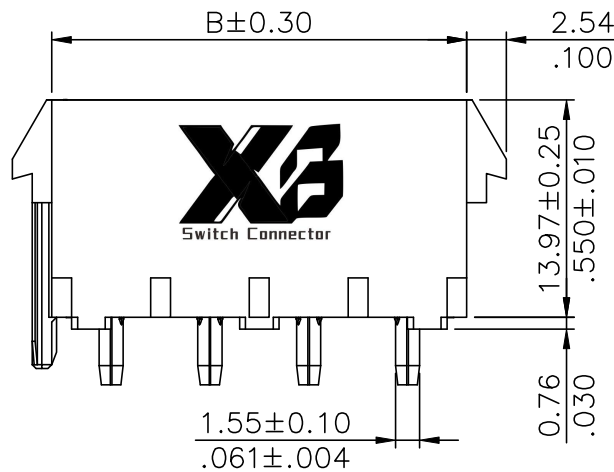

### Ordering Code:

CP08 \*\* P 1 V C S  
 ① ② ③ ④ ⑤ ⑥ ⑦

- ① Series No.
- ② No. of Circuits: 02~06, 08, 10
- ③ Contact type: P = Plug
- ④ Contact plated:  
1 = Tin over Nickel
- ⑤ V= Straight
- ⑥ Material: C= Nylon 66, UL 94V-0
- ⑦ Other options:  
S = Female Pin, With Peg  
S-N = Female Pin, Without Peg

P/N: CP08\*\*P1VCS-N (without peg)

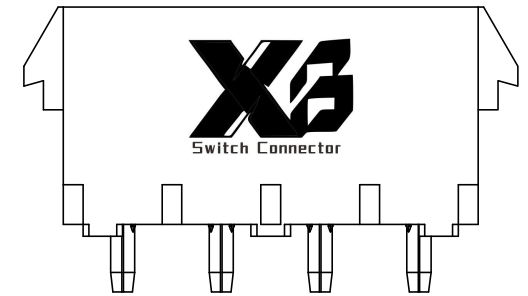

Tin-Lead Process

RoHS Compliant

④					DATE	UNIT: mm / inch	TITLE: 6.35mm PITCH STRAIGHT HEADER POWER CONNECTOR
③				DRAWN BY:	Eric	3/8-24'	TOLERANCE UNLESS OTHERWISE SPECIFIED
②				ENGINEER:	Eric	3/8-24'	
①	Eric	3/8-24'	ECNT124055	CHECKED BY:	Eisley	3/8-24'	MATERIAL:
SYM	NAME	DATE	REVISIONS	APPROVED BY:	Eisley	3/8-24'	FINISH:



东莞市溪榜电子有限公司  
 DONG GUAN XI BANG ELECTRONICS CO., LTD.

DRAWING NO.	CP0811SB	PART NO.	CP08**P1VCS CP08**P1VCS-N
SCALE	2 / 1	SHEET	1 OF 2

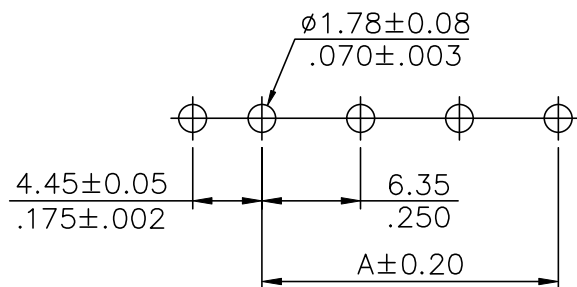
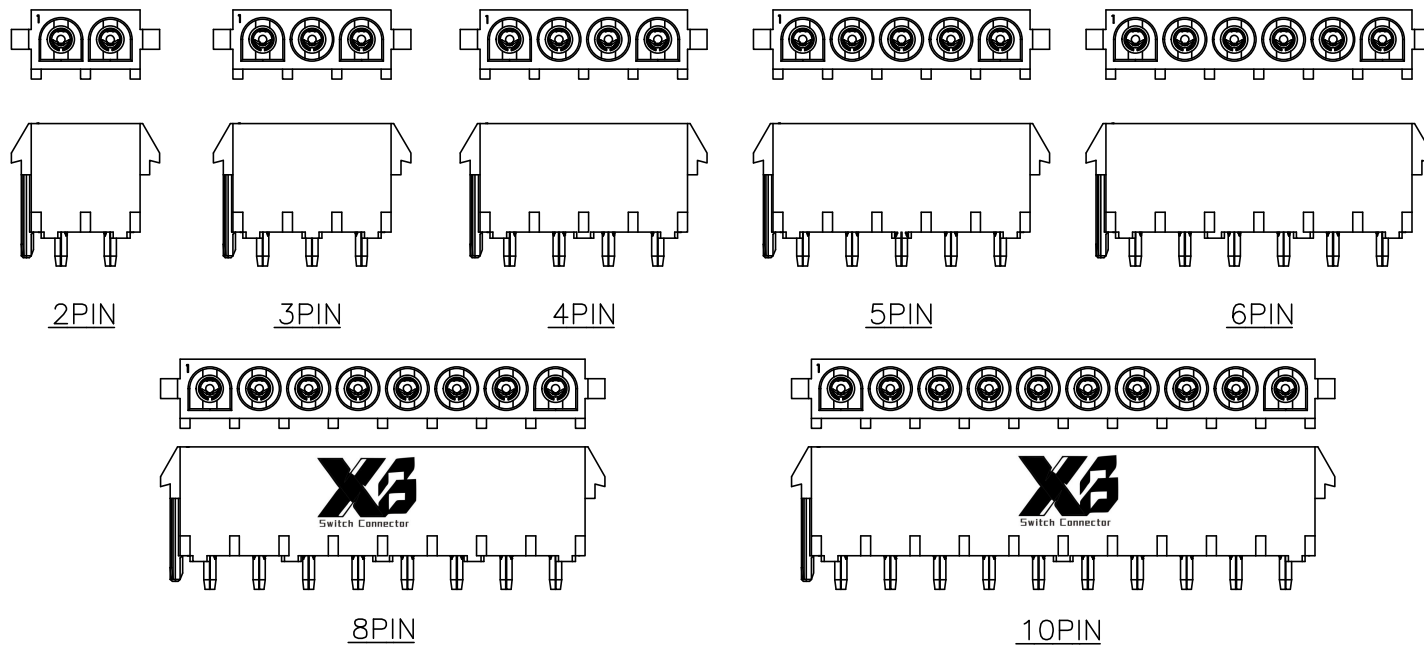

With Peg

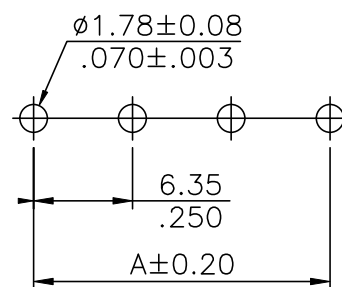

Without Peg

Recommended P.C. Board layout

Circuits	Dimension
	A
2	6.35(.250)
3	12.70(.500)
4	19.05(.750)
5	25.40(1.000)
6	31.75(1.250)
8	44.45(1.750)
10	57.15(2.250)

Tin-Lead Process

RoHS Compliant

4					DATE	UNIT: mm / inch	TITLE: 6.35mm PITCH STRAIGHT HEADER POWER CONNECTOR
3				DRAWN BY: Eric	3/8-24'	TOLERANCE UNLESS OTHERWISE SPECIFIED	
2				ENGINEER: Eric	3/8-24'	.X ± 0.30/.012 X' ± 1'	MATERIAL:
1	Eric	3/8-24'	ECNT124055	CHECKED BY: Eisley	3/8-24'	.XX ± 0.20/.008 .X' ±	FINISH:
SYM	NAME	DATE	REVISIONS	APPROVED BY: Eisley	3/8-24'	.XXX ± 0.10/.004 .XX' ±	



东莞市溪榜电子有限公司  
DONG GUAN XI BANG ELECTRONICS CO., LTD.

DRAWING NO.	CP0811SB	PART NO.	CP08**P1VCS CP08**P1VCS-N
SCALE	2 / 1	SHEET	2 OF 2