

Notes:

- Material:  
Insulation: Nylon 6, Color Nature  
Contact: Brass
- Circuit Pattern Schedule:  
See Drawing No: CP0111S\*
- Glow wire requirement:  
IEC 60695-2-12 GWFI  
960°C@0.38mm  
& 930°C@0.75mm  
& 960°C@1.50mm  
& 960°C@3.00mm  
IEC 60695-2-11 GWEPT 750°C ≤2S

Part No.	Dimension	
	C	D
CP-013**1J0	9.20(.362)	3.50(.138)
CP-013**1JA	9.20(.362)	17.00(.669)
CP-013**1JB	9.20(.362)	28.00(1.102)
CP-013**1JC	9.20(.362)	23.80(.937)
CP-013**1JE	9.20(.362)	5.00(.197)
CP-013**1JF	9.20(.362)	13.00(.512)
CP-013**1JG	10.20(.402)	3.50(.138)

Ordering Code:

CP-01 3 \*\* \* J \*

① ② ③ ④ ⑤ ⑥

- Series No.
- Type of Connector:  
3= Straight PCB mount header
- No of Circuits:
- Plating Code:  
1= 3.05 μm(120 μ") Tin over 0.76 μm(30 μ") Nickel  
2= Gold flash plated over Nickel  
3= 0.38 μm(15 μ") Gold plated over 1.27 μm(50 μ") Nickel  
4= 0.76 μm(30 μ") Gold plated over 1.27 μm(50 μ") Nickel
- Variation:  
J= Nylon 6 UL 94V-2 , Color Nature with SQ pin (Glow wire available)
- Pin Length Code: Pin Length= Dim.C ; Dim.D

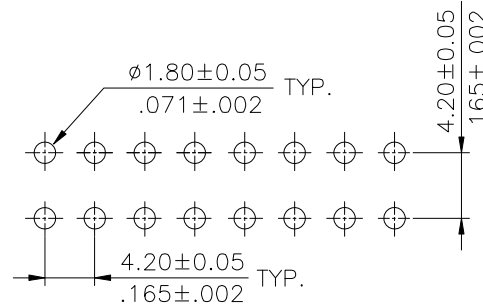
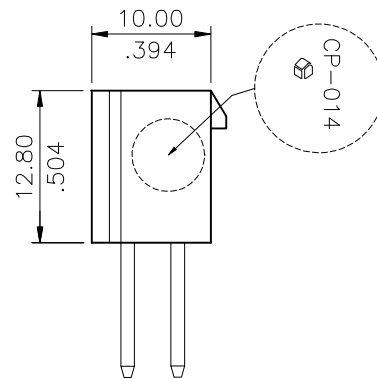
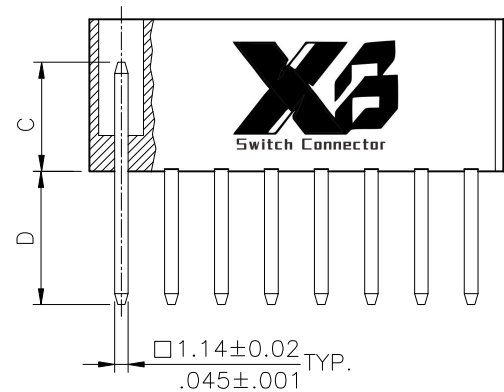
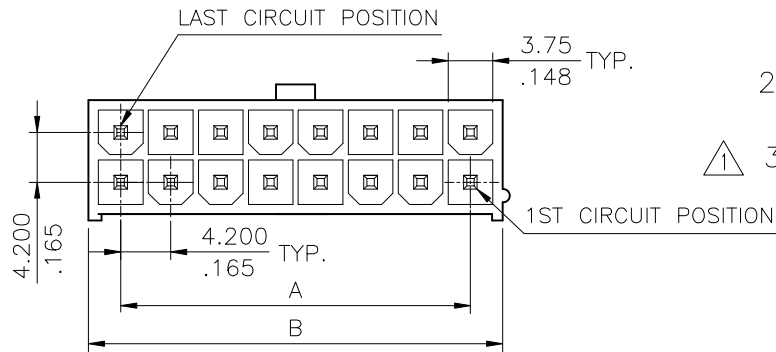

Recommended P.C. Board Layout

Tin-Lead Process

RoHS compliant

SYM	NAME	DATE	REVISIONS	APPROVED BY:	DATE	UNIT: mm / inch	TITLE: STRAIGHT HEADER CP-01 POWER CONNECTOR	MATERIAL:	FINISH:	DRAWING NO. CP0148AB	PART NO. CP-013***J*	SCALE 2 / 1	SHEET 1 OF 1
④					DATE	UNIT: mm / inch	TITLE: STRAIGHT HEADER CP-01 POWER CONNECTOR						
③				DRAWN BY: Kenny	9/2-20'	TOLERANCE UNLESS OTHERWISE SPECIFIED							
②				ENGINEER: Sun	9/2-20'	.X ± 0.38/.015 X' ± r							
①	Kenny	8/26-20'	ECNT120227	CHECKED BY: Eisley	9/4-20'	.XX ± 0.25/.010 X' ±							
				APPROVED BY: Eisley	9/4-20'	.XXX ± 0.10/.004 X' ±							



东莞市溪榜电子有限公司  
DONG GUAN XI BANG ELECTRONI CS CO., LTD.