

② ④

Material:

⑤ * Insulation: High Temperature Plastic
Color Black

* Contact: Brass

CIRCUITS	DIM. A	DIM. B	DIM. C
2	—	6.7(.264)	3.0(.118)
4	3.00(.118)	9.7(.382)	3.0(.118)
6	6.00(.236)	12.7(.500)	3.0(.118)
8	9.00(.354)	15.7(.618)	7.7(.303)
10	12.00(.472)	18.7(.736)	10.7(.421)
12	15.00(.591)	21.7(.854)	13.7(.539)
14	18.00(.709)	24.7(.972)	16.7(.657)
16	21.00(.827)	27.7(1.091)	19.7(.776)
18	24.00(.945)	30.7(1.209)	22.7(.894)
20	27.00(1.063)	33.7(1.327)	25.7(1.012)
22	30.00(1.181)	36.7(1.445)	28.7(1.130)
24	33.00(1.299)	39.7(1.563)	31.7(1.248)

Ordering Code:

CP35 ** P * H S P
① ② ③ ④ ⑤ ⑥ ⑦

① Series No.

② No. of Circuits: 02~24

③ Contact type: P= Plug

④ Contact plated:

1= Tin Plated over Nickel

A= Selective Gold Flash Plated over 1.27μm(50μ") Nickel

B= Selective 0.38μm(15μ") Gold Plated over 1.27μm(50μ") Nickel

C= Selective 0.76μm(30μ") Gold Plated over 1.27μm(50μ") Nickel

⑤ H= Right angle type

⑥ Mount type: S= SMT Type

⑦ Other options:

P= With plastic board lock

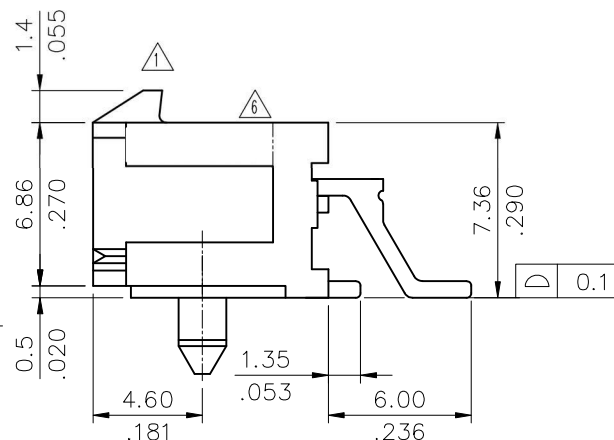
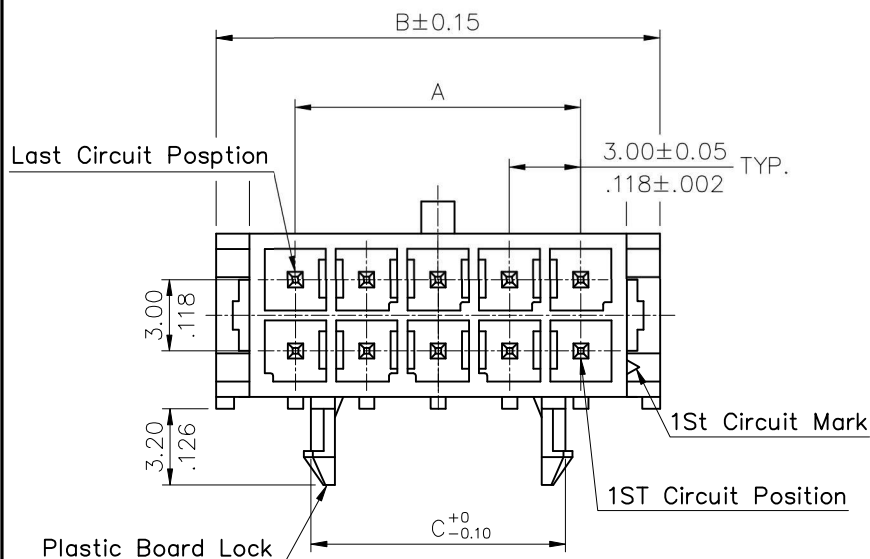

RoHS Compliant

SYM	NAME	DATE	REVISIONS	APPROVED BY:	DATE	UNIT: mm / inch	TITLE: 3.00mm PITCH RIGHT ANGLE SMT TYPE POWER CONN.	MATERIAL:			FINISH:		
⑥	Eric	3/29-21'	ECRT121017/ECNT121085					DRAWN BY: Eric			DATE: 3/29-21'		
⑤	Michelle	11/12-19'	ECRB11905/ECNT119313					ENGINEER: Sun			DATE: 3/31-21'		
④	Sun	9/18-06'	ECR06083-0/ECN06330					CHECKED BY: Eisley			DATE: 4/1-21'		
③	Sun	2/12-05	ECN05428					APPROVED BY: Eisley			DATE: 4/1-21'		
								TOLERANCE UNLESS OTHERWISE SPECIFIED					
								.X ± 0.30/.012			.X' ± 1'		
								.XX ± 0.20/.008			.X' ±		
								.XXX ± 0.10/.004			.XX' ±		
								DRAWING NO. CP3509SJ			PART NO.		CP35**P*HSP
								SCALE 3 / 1			SHEET 1 OF 2		

XGB 东莞市溪榜电子有限公司
DONG GUAN XI BANG ELECTRONICS CO., LTD.

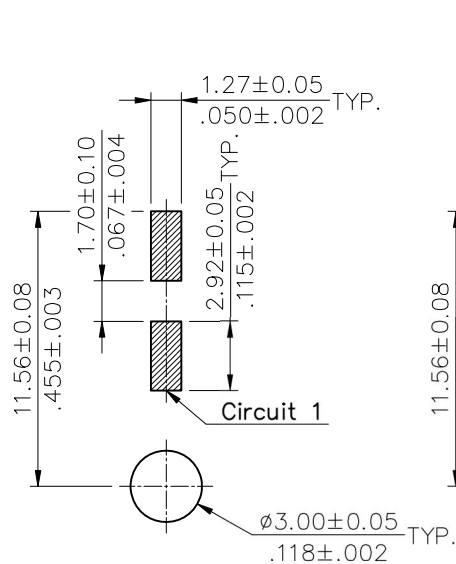

2 Circuits

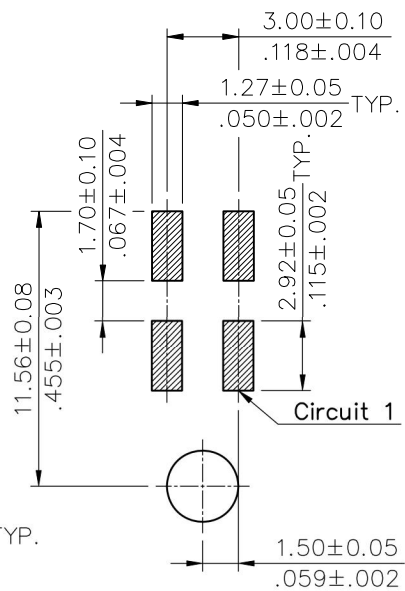

4 Circuits

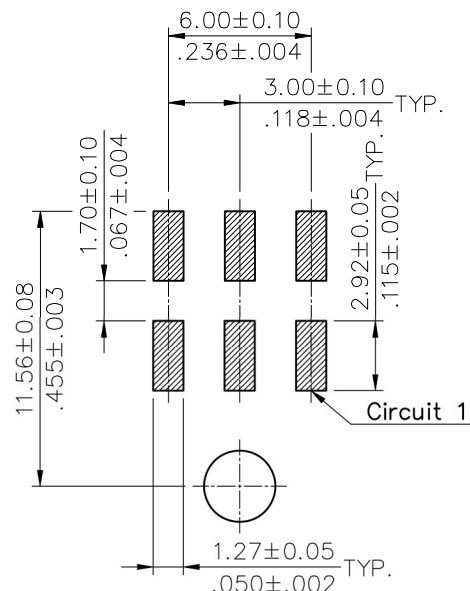

6 Circuits

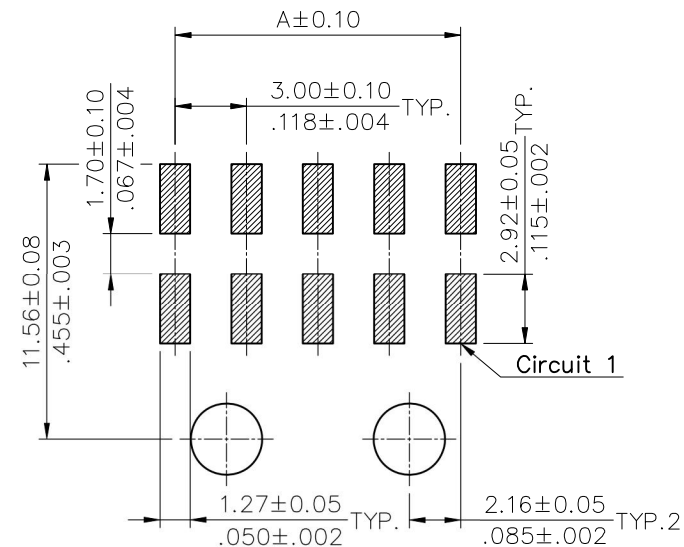

8 ~ 24 Circuits

Recommended P.C. Board Layout

RoHS Compliant

6	Eric	3/29-21'	ECRT121017/ECNT121085		DATE	UNIT: mm / inch	TITLE: 3.00mm PITCH RIGHT ANGLE SMT TYPE POWER CONN.	东莞市溪榜电子有限公司 DONG GUAN XI BANG ELECTRONICS CO., LTD.
5	Michelle	11/12-19'	ECRB11905/ECNT119313	DRAWN BY: Eric	3/29-21'	TOLERANCE UNLESS OTHERWISE SPECIFIED	MATERIAL:	
4	Sun	9/18-06'	ECR06083-0/ECN06330	ENGINEER: Sun	3/31-21'	.X ± 0.30/012 .X' ± 1"	FINISH:	
3	Sun	2/12-05	ECN05428	CHECKED BY: Eisley	4/1-21'	.XX ± 0.20/008 .X' ±		
SYM	NAME	DATE	REVISIONS	APPROVED BY: Eisley	4/1-21'	.XXX ± 0.10/004 .XX' ±		DRAWING NO. CP3509SJ PART NO. CP35**P*HSP
								SCALE 3 / 1 SHEET 2 OF 2

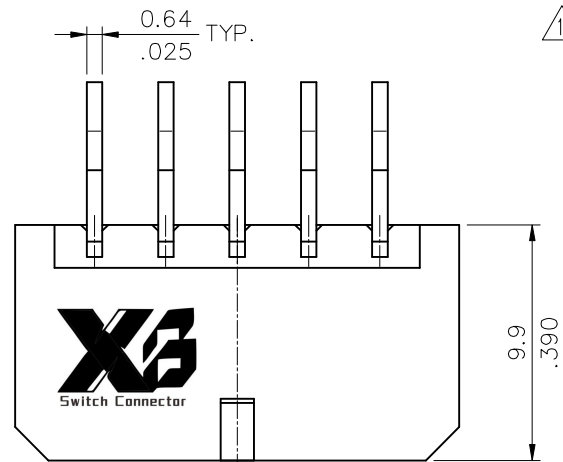

Material:
 △ * Insulation: High Temperature Plastic
 Color Black
 * Contact: Brass

CIRCUITS	DIM. A	DIM. B	DIM. C
2	—	6.7(.264)	3.0(.118)
4	3.00(.118)	9.7(.382)	3.0(.118)
6	6.00(.236)	12.7(.500)	3.0(.118)
8	9.00(.354)	15.7(.618)	7.7(.303)
10	12.00(.472)	18.7(.736)	10.7(.421)
12	15.00(.591)	21.7(.854)	13.7(.539)
14	18.00(.709)	24.7(.972)	16.7(.657)
16	21.00(.827)	27.7(1.091)	19.7(.776)
18	24.00(.945)	30.7(1.209)	22.7(.894)
20	27.00(1.063)	33.7(1.327)	25.7(1.012)
22	30.00(1.181)	36.7(1.445)	28.7(1.130)
24	33.00(1.299)	39.7(1.563)	31.7(1.248)

Ordering Code:

CP35 ① ② ③ ④ ⑤ ⑥ ⑦ ⑧

- ① Series No.
- ② No. of Circuits: 02~24
- ③ Contact type: P= Plug
- ④ Contact plated:

- 1= Matte Tin Plated over Nickel
- A= Selective Gold Flash Plated over 1.27μm(50μ") Nickel
- B= Selective 0.38μm(15μ") Gold Plated over 1.27μm(50μ") Nickel
- C= Selective 0.76μm(30μ") Gold Plated over 1.27μm(50μ") Nickel

- ⑤ H= Right angle type
- ⑥ Mount type: S= SMT Type
- ⑦ Other options:
P= With plastic board lock
- ⑧ LF= For Lead Free IR Process

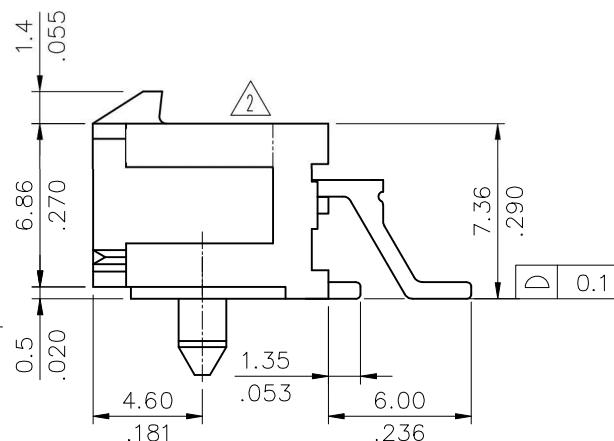
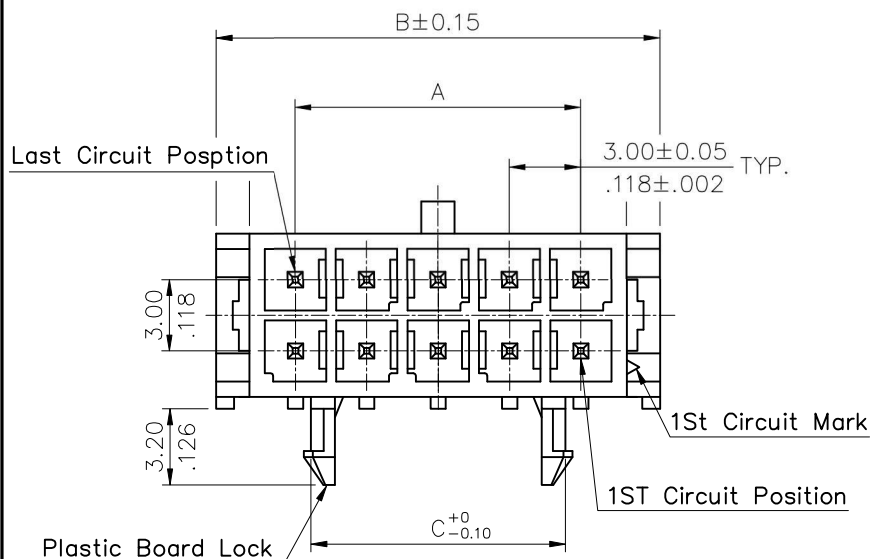

Lead Free Process

RoHS Compliant

SYM	NAME	DATE	REVISIONS	APPROVED BY:	DATE	UNIT: mm / inch	TITLE: 3.00mm PITCH RIGHT ANGLE SMT TYPE POWER CONN.
△4							
△3				DRAWN BY: Eric	3/29-21'	TOLERANCE UNLESS OTHERWISE SPECIFIED .X ± 0.30/.012 .X' ± 1" .XX ± 0.20/.008 .X' ± .XXX ± 0.10/.004 .XX' ±	MATERIAL:
△2	Eric	3/29-21'	ECRT121017/ECNT121085	ENGINEER: Sun	3/31-21'		
△1	Michelle	11/12-19'	ECRB11905/ECNT119313	CHECKED BY: Eisley	4/1-21'		
				APPROVED BY: Eisley	4/1-21'		
FINISH:							
DRAWING NO. CP3597SC		PART NO. CP35**P*HSP-LF		SCALE 3 / 1		SHEET 1 OF 2	



东莞市溪榜电子有限公司
 DONG GUAN XI BANG ELECTRONI CS CO., LTD.

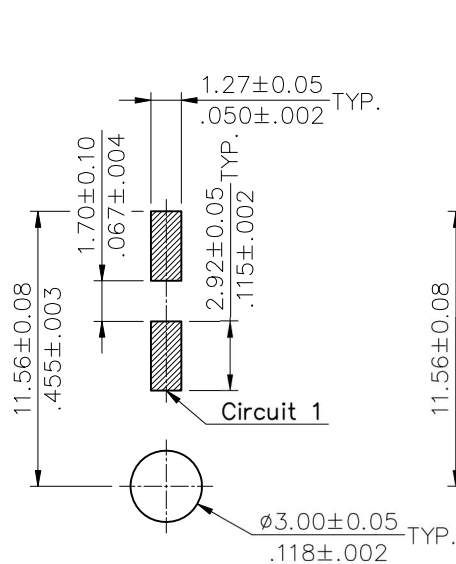

2 Circuits

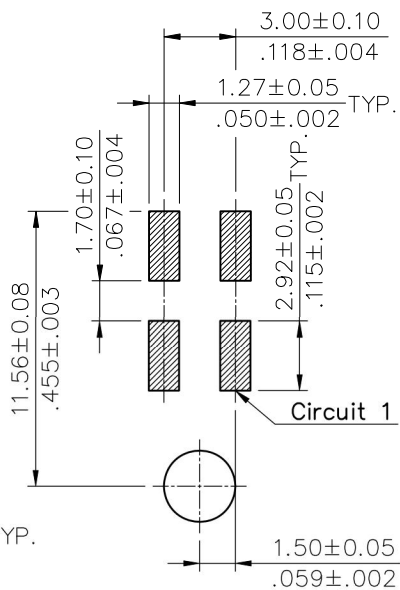

4 Circuits

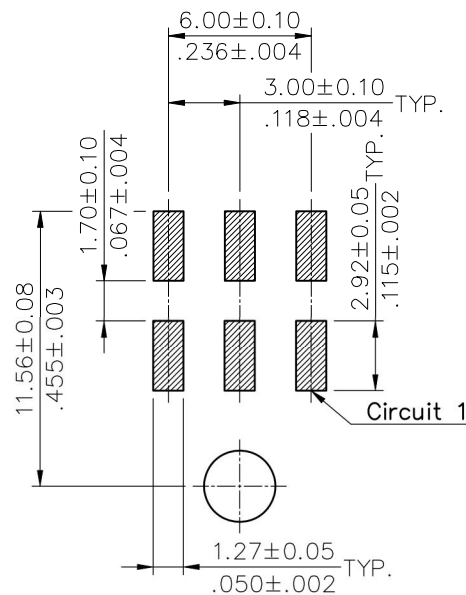

6 Circuits

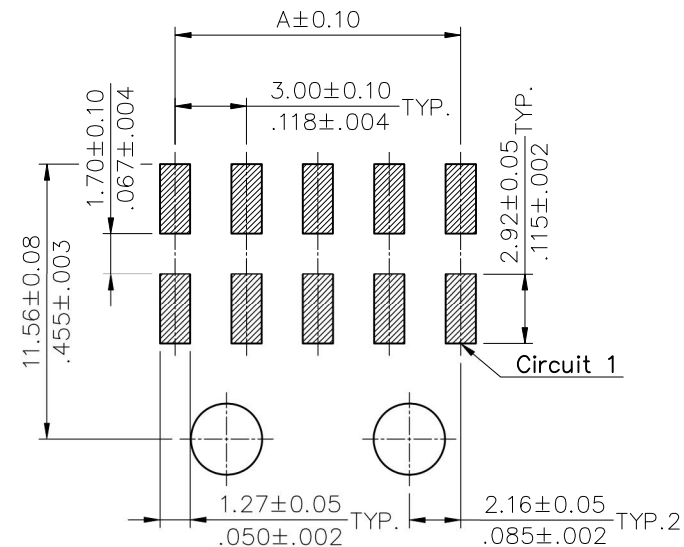

8 ~ 24 Circuits

Recommended P.C. Board Layout

Lead Free Process RoHS Compliant

4					DATE	UNIT: mm / inch	TITLE: 3.00mm PITCH RIGHT ANGLE SMT TYPE POWER CONN.	东莞市溪榜电子有限公司 DONG GUAN XI BANG ELECTRONI CS CO., LTD.
3				DRAWN BY: Eric	3/29-21'	TOLERANCE UNLESS OTHERWISE SPECIFIED	MATERIAL:	
2	Eric	3/29-21'	ECRT121017/ECNT121085	ENGINEER: Sun	3/31-21'	.X ± 0.30/012 X' ± 1'	FINISH:	DRAWING NO. CP3597SC PART NO. CP35**P*HSP-LF
1	Michelle	11/12-19'	ECRB11905/ECNT119313	CHECKED BY: Eisley	4/1-21'	.XX ± 0.20/008 .X' ±		SCALE 3 / 1 SHEET 2 OF 2
SYM	NAME	DATE	REVISIONS	APPROVED BY: Eisley	4/1-21'	.XXX ± 0.10/004 .XX' ±		