

# Ordering Code:

CP35 \*\* P \* V 0 0 - S - LF  
 ① ② ③ ④ ⑤ ⑥ ⑦ ⑧ ⑨

Material:

- △ \* Insulation: High Temperature Plastic  
 UL 94V-0, Color Black
- \* Contact: Brass

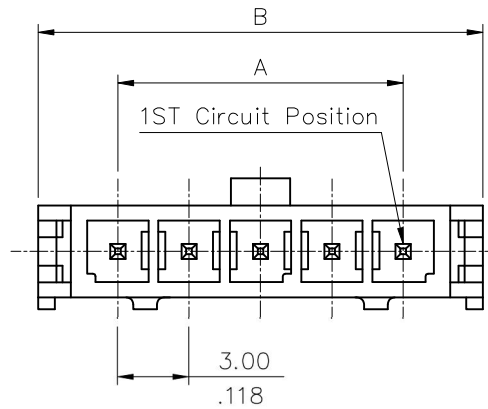

- ① Series No.
- ② No. of Circuits: 02~12
- ③ Contact type: P = Plug
- ④ Contact plated:
  - 1= Matte Tin over Nickel
  - 2= Gold flash plated over 50 μ" Nickel
  - 3= 15 μ" Gold plated over 50 μ" Nickel
  - 4= 30 μ" Gold plated over 50 μ" Nickel
- ⑤ V= Straight
- ⑥ Mount type : 0= DIP Type
- ⑦ Other options: 0= With pegs(Standard)
- ⑧ S= Single Row Header
- ⑨ LF= Lead Free soldering process

CIRCUITS	DIM.A	DIM.B	DIM.C
2	3.00(.118)	9.65(.380)	9.0(.354)
3	6.00(.236)	12.65(.498)	12.0(.472)
4	9.00(.354)	15.65(.616)	15.00(.591)
5	12.00(.472)	18.65(.734)	18.00(.709)
6	15.00(.591)	21.65(.852)	21.00(.827)
7	18.00(.709)	24.65(.970)	24.00(.945)
8	21.00(.827)	27.65(1.089)	27.00(1.063)
9	24.00(.945)	30.65(1.207)	30.00(1.181)
10	27.00(1.063)	33.65(1.325)	33.00(1.299)
11	30.00(1.181)	36.65(1.443)	36.0(1.417)
12	33.00(1.299)	39.65(1.561)	39.0(1.535)

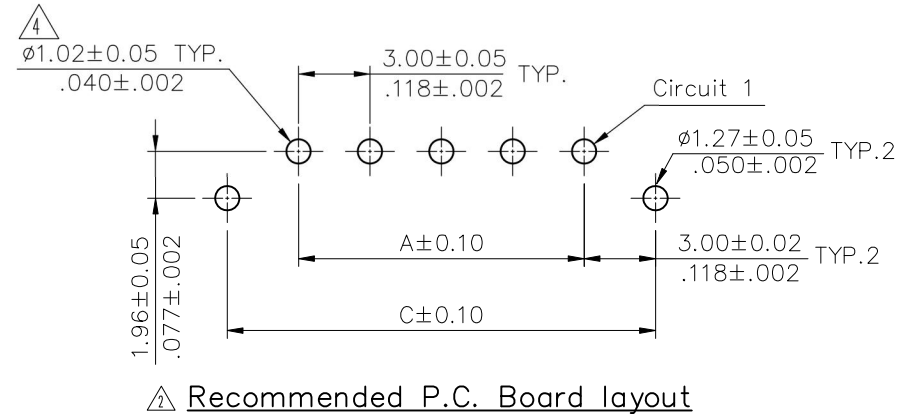
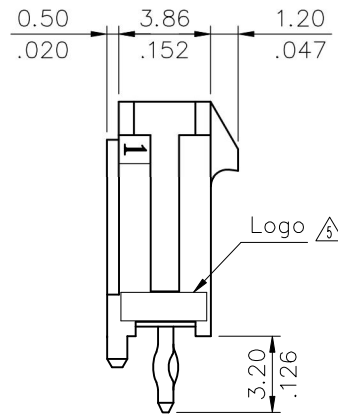
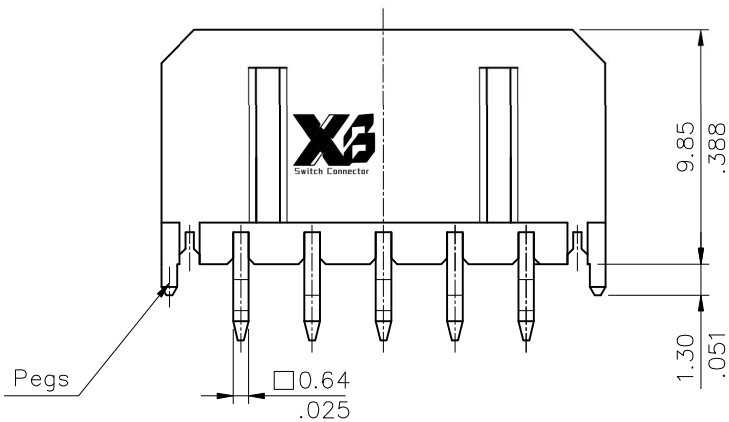

Lead Free Process      RoHS Compliant

SYM	NAME	DATE	REVISIONS	APPROVED BY:	DATE	UNIT: mm / inch	TITLE: 3.00mm PITCH STRAIGHT HEADER POWER CONNECTOR	
△5	Eric	3/29-21'	ECRT121017/ECNT121085					
△4	Kenny	8/20-20'	ECNT120218	DRAWN BY: Eric	3/29-21'	TOLERANCE UNLESS OTHERWISE SPECIFIED	MATERIAL:	
△3	Yushu	4/11-19'	ECRB118091/ECNT119092	ENGINEER: Sun	3/31-21'			.X ± 0.30/.012    X' ± 1'
△2	Karen	7/16-09'	ECN09363	CHECKED BY: Eisley	4/1-21'			.XX ± 0.20/.008    .X' ±
				APPROVED BY: Eisley	4/1-21'			.XXX ± 0.10/.004    .XX' ±

**东 莞 市 溪 榜 电 子 有 限 公 司**  
 DONG GUAN XI BANG ELECTRONIC CO., LTD.

DRAWING NO. **CP3565SE**    PART NO. **CP35\*\*P\*V00-S-LF**

SCALE    3 / 1    SHEET    1    OF    1

# Ordering Code:

CP35 \*\* P \* V 0 0 - S - NH  
 ① ② ③ ④ ⑤ ⑥ ⑦ ⑧ ⑨

Note:

- \* Insulation: High Temperature Polyamide 94V-0, Color Black
- \* Contact: Brass
- \* For Lead Free wave flow process

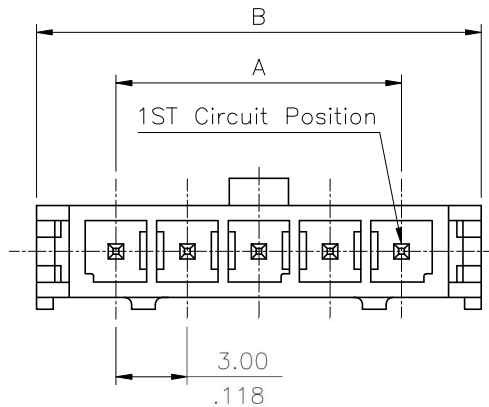

- ① Series No.
- ② No. of Circuits: 02~12
- ③ Contact type: P = Plug
- ④ Contact plated:
  - 1= Matte Tin over Nickel
  - 2= Gold flash plated over 50μ " Nickel
  - 3= 15μ " Gold plated over 50μ " Nickel
  - 4= 30μ " Gold plated over 50μ " Nickel
- ⑤ V= Straight
- ⑥ Mount type : 0= DIP Type
- ⑦ Other options: 0= With pegs(Standard)
- ⑧ S= Single Row Header
- ⑨ NH= Lead Free wave flow process and Halogen Free

CIRCUITS	DIM.A	DIM.B	DIM.C
2	3.00(.118)	9.65(.380)	9.0(.354)
3	6.00(.236)	12.65(.498)	12.0(.472)
4	9.00(.354)	15.65(.616)	15.00(.591)
5	12.00(.472)	18.65(.734)	18.00(.709)
6	15.00(.591)	21.65(.852)	21.00(.827)
7	18.00(.709)	24.65(.970)	24.00(.945)
8	21.00(.827)	27.65(1.089)	27.00(1.063)
9	24.00(.945)	30.65(1.207)	30.00(1.181)
10	27.00(1.063)	33.65(1.325)	33.00(1.299)
11	30.00(1.181)	36.65(1.443)	36.0(1.417)
12	33.00(1.299)	39.65(1.561)	39.0(1.535)

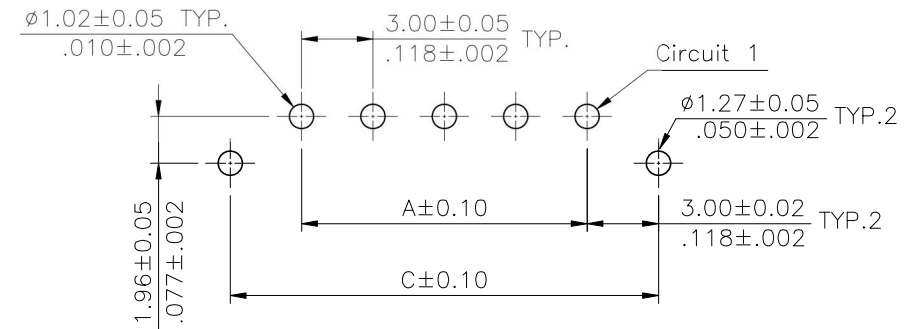
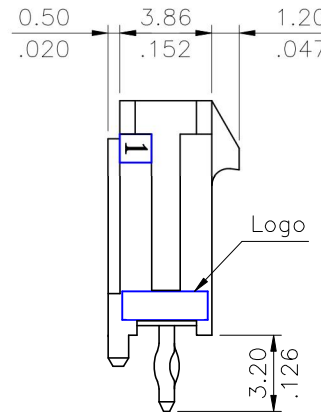
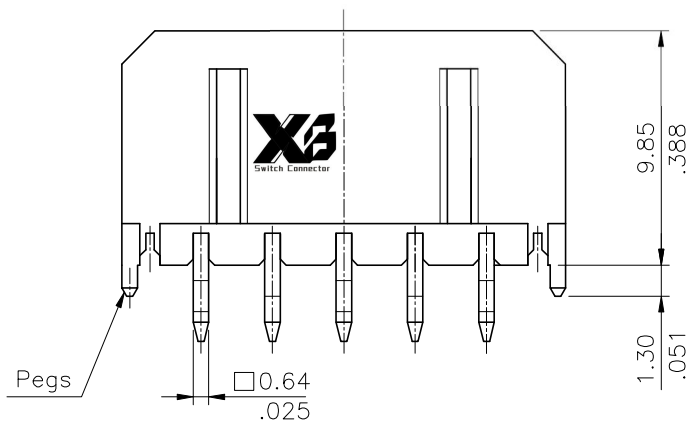

Recommended P.C. Board layout

Halogen-Free    Lead Free Process    RoHS compliant

SYM	NAME	DATE	REVISIONS	APPROVED BY:	Eisley	10/7-21'	.XXX ± 0.10/004	.XX' ±	TITLE: 3.00mm PITCH STRAIGHT HEADER POWER CONNECTOR	MATERIAL:	FINISH:	DRAWING NO. CP35134SA	PART NO. CP35**P*V00-S-NH	SCALE 3 / 1	SHEET 1 OF 1
4						DATE	UNIT: mm / inch								
3				DRAWN BY:	Sun	10/6-21'	TOLERANCE UNLESS OTHERWISE SPECIFIED								
2				ENGINEER:	Sun	10/6-21'	.X ± 0.30/012	X' ± 1'							
1				CHECKED BY:	Eisley	10/7-21'	.XX ± 0.20/008	.X' ±							

**X3** 东莞市溪榜电子有限公司  
 Switch Connector DONG GUAN XI BANG ELECTRONICS CO., LTD.