

Ordering Code:

$\frac{CI91}{①}$ $\frac{**}{②}$ $\frac{SB}{③}$ $\frac{00}{④}$ $\frac{0}{⑤}$

- ① Series No.
- ② No. of Circuits:
- ③ Accommodated wire style:
SB= For Discrete Wire, Split Ribbon Cable and Notched Flat Cable
- ④ Insulator: 00= Nylon, UL 94V-0, Color Nature
01= PBT, UL 94V-0, Color Nature(White)
- ⑤ Other option: 0= DIM.D=1.60; DIM.E=1.60(Standard)

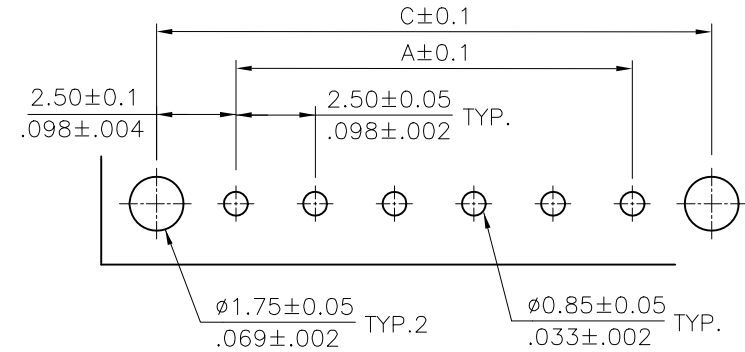
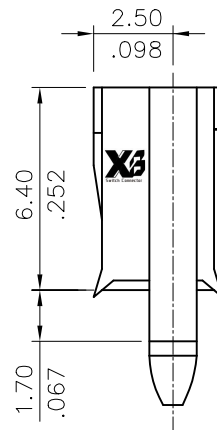
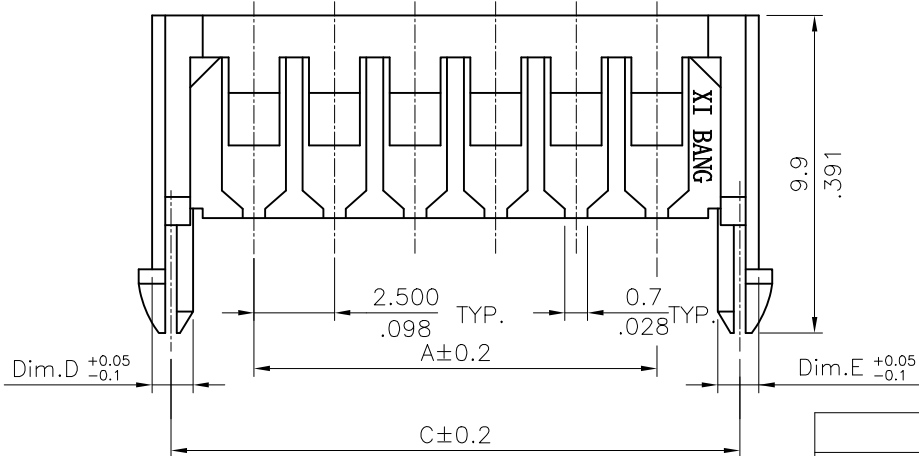
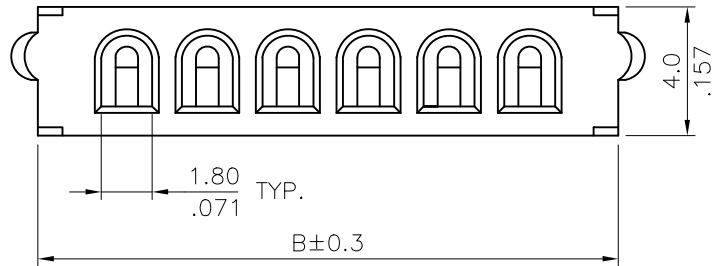

Recommended P.C. Board Layout

A = 2.5 * No. of Spaces

B = A + 5.3

C = A + 5.0

* Available in 2 through 5, 7 & 8 circuits

ACCOMMODATED WIRE SIZE: AWG#24~#26

Discrete Wire	Split Ribbon Cable	Notched Flat Cable

RoHS Compliant

⑤	Karen	8/25-14'	ECNT114188/ECRT114074		DATE	UNIT: mm / inch	TITLE: 2.50MM(.098") WIRE HOLDER CONNECTOR	东莞市溪榜电子有限公司 DONG GUAN XI BANG ELECTRONI CS CO., LTD.			
④	Enya	3/7-13'	ECN13058-0/ECR13023-0	DRAWN BY: Karen	8/27-14'	TOLERANCE UNLESS OTHERWISE SPECIFIED	MATERIAL:				
③	SUN	4/16/04'	ECN04155	ENGINEER: Sun	8/27-14'	.X ± 0.30/.012 X' ± 1'	FINISH:				
②	Eisley	3/09/04'	ECN04097	CHECKED BY: Eisley	8/28-14'	.XX ± 0.20/.008 X' ±					
SYM	NAME	DATE	REVISIONS	APPROVED BY: Eisley	8/28-14'	.XXX ± 0.10/.004 .XX' ±					
DRAWING NO.		CI9101SI		PART NO.		CI91**SB0*0		SCALE	4 / 1	SHEET	1 OF 1

Ordering Code:

$\frac{CI91}{①}$ $\frac{**}{②}$ $\frac{SA}{③}$ $\frac{00}{④}$ $\frac{0}{⑤}$

- ① Series No.
- ④ ③ No. of Circuits:
- ③ Connector style:
SA= For Flat Cable
- ④ Insulator: 00= Nylon, UL 94V-0, Color Nature
01= PBT, UL 94V-0, Color Nature(White)
- ⑤ Other option: 0= DIM.D=1.60; DIM.E=1.60(Standard)

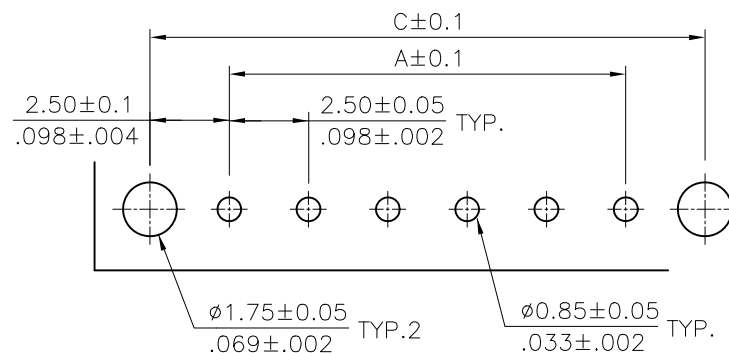
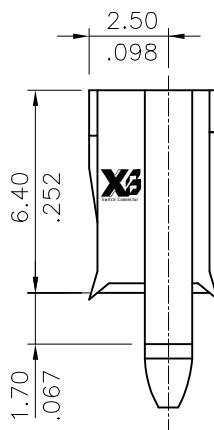
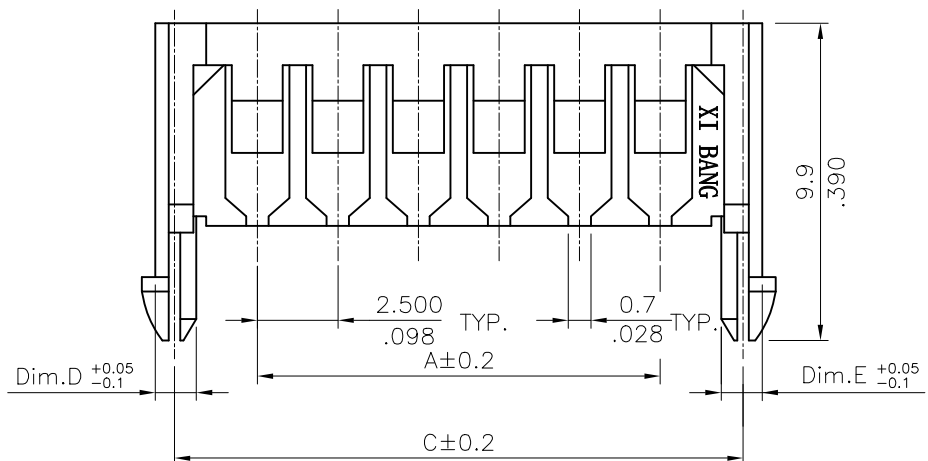
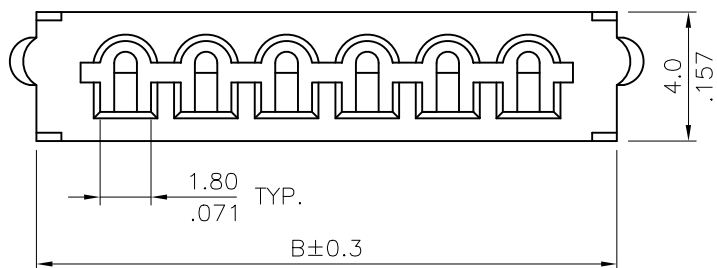

Recommended P.C. Board Layout

A = 2.5 * No. of Spaces

B = A + 5.3

C = A + 5.0

④ * Available in 3 & 6 circuits

ACCOMMODATED WIRE SIZE: AWG#24~#26

Flat Cable

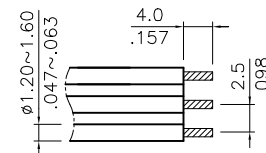

RoHS Compliant

④	Karen	8/25-14'	ECNT114188/ECRT114074		DATE	UNIT: mm / inch	TITLE: 2.50MM(.098") WIRE HOLDER CONNECTOR	东莞市溪榜电子有限公司 DONG GUAN XI BANG ELECTRONICS CO., LTD.
③	Enya	3/7-13'	ECN13058-0/ECR13023-0	DRAWN BY: Karen	8/27-14'	TOLERANCE UNLESS OTHERWISE SPECIFIED	MATERIAL:	
②	SUN	4/16/04'	ECN04155	ENGINEER: Sun	8/27-14'	.X ± 0.30 / .012 .X' ± 1"	FINISH:	
①	SUN	2/06/04'	ECN04053	CHECKED BY: Eisley	8/28-14'	.XX ± 0.20 / .008 .X' ±		
SYM	NAME	DATE	REVISIONS	APPROVED BY: Eisley	8/28-14'	.XXX ± 0.10 / .004 .XX' ±		DRAWING NO. CI9102SE PART NO. CI91**SA0*0 SCALE 4 / 1 SHEET 1 OF 1