

ORDERING CODE

CI43 ** M * H R A -NH
 ① ② ③ ④ ⑤ ⑥ ⑦ ⑧

- ① Series No.
- ② Contact:
- ③ M= SMT Type Header
- ④ Plating :
 1= Matte Tin Plated over Nickel
 2= Gold flash plated over 1.27um(50u") Nickel
- ⑤ Type : H= Side entry
- ⑥ Packing option:
 R= Tape & Reel Packing
- ⑦ Other option:
 A= Base Hight 1.90 For Customer Assigned
- ⑧ -NH= For Lead Free IR Processes and Halogen-Free

Material :

- * Base : LCP
- * Contact : Brass
- * Fixed tab : Brass

DIM. A = 1.25 x NO. OF SPACES
 DIM. B = DIM. A + 4.75
 DIM. C = DIM. A + 2.05
 DIM. D = DIM. A + 0.60
 DIM. E = DIM. A - 1.26
 * AVAILABLE 4.5.6.8 PIN

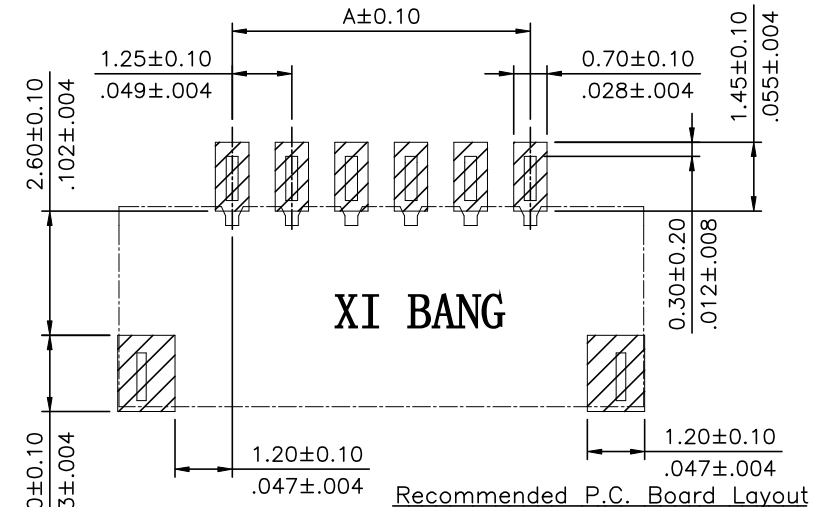
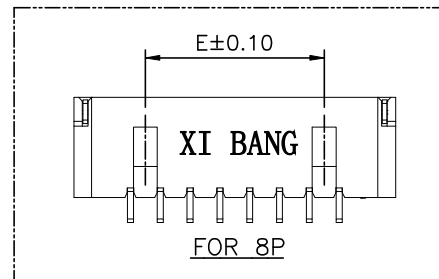
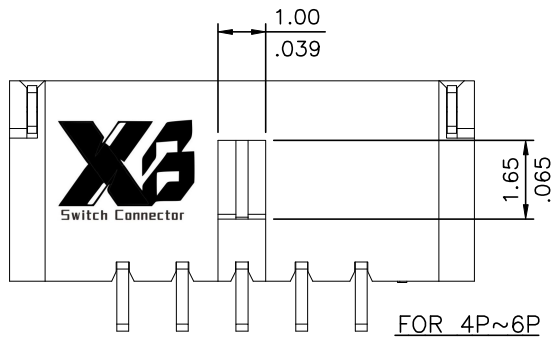
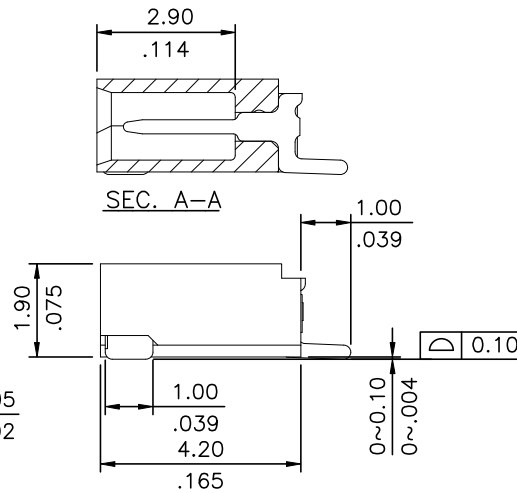
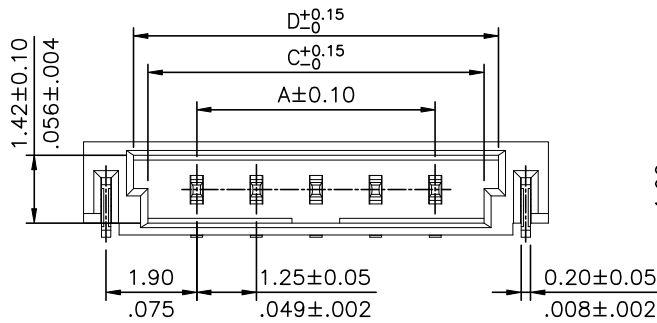
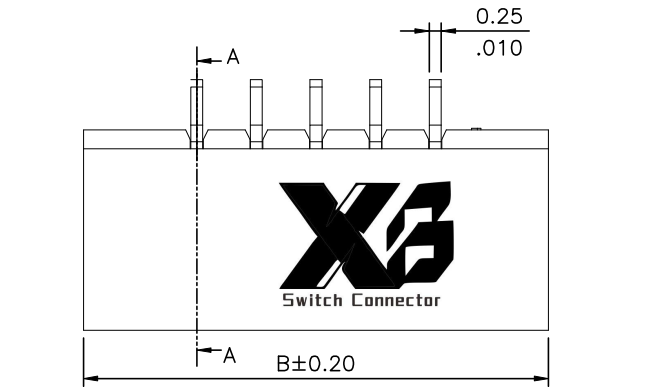

Halogen-Free RoHS Compliant

④					DATE	UNIT: mm / inch	TITLE: 1.25mm Pitch WTB SMT R/A TYPE	东莞市溪榜电子有限公司 DONG GUAN XI BANG ELECTRONI CS CO., LTD.
③				DRAWN BY: Jack	12/27-23'	TOLERANCE UNLESS OTHERWISE SPECIFIED	MATERIAL:	
②				ENGINEER: Sun	12/27-23'	.X ± 0.30/.012 X.' ± 1'	FINISH:	DRAWING NO. CI4319SB
①	Jack	12/27-23'	ECNT123179/ECRB123029	CHECKED BY: Eisley	12/27-23'	.XX ± 0.20/.008 X.' ±		PART NO. CI43**M*HRA-NH
SYM	NAME	DATE	REVISIONS	APPROVED BY: Eisley	12/27-23'	.XXX ± 0.10/.004 X.' ±	SCALE 6 / 1	SHEET 1 OF 2

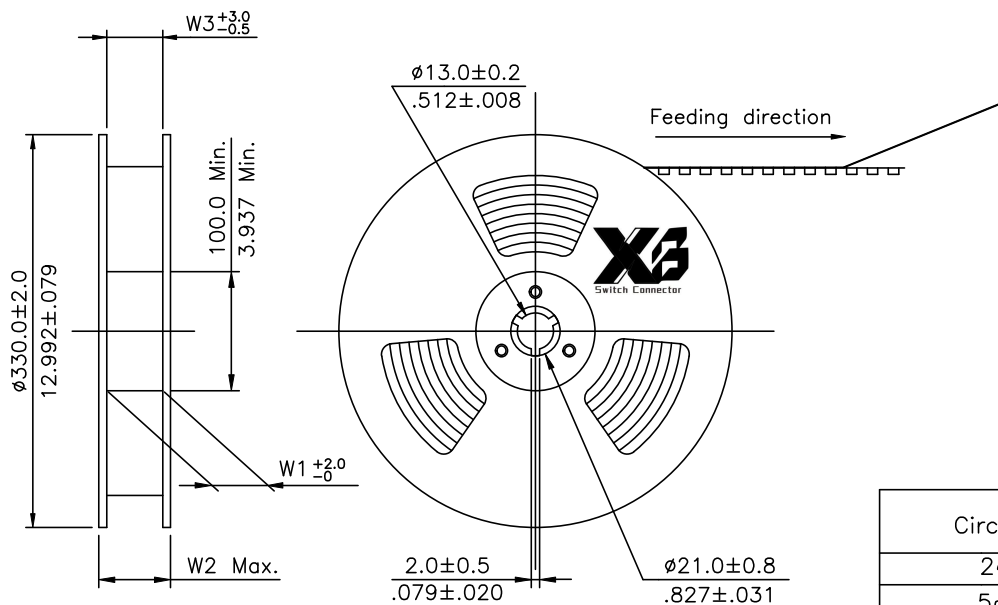

1 NOTES:

1. Reel Material : HIPS
2. 10 sprocket hole pitch cumulative tolerance ± 0.20
3. Carrier camber is within 1 mm in 250 mm.
4. Material :Black, Polystyrene alloy
5. All dimensions meet EIA-481 requirements.
6. Thickness : 0.30 ± 0.05 mm.
7. Quantity : 2000 pcs.

Circuits	Dimension					Packing (Reel/Carton)
	E	F	W1	W2	W3	
2~4	16.0(.630)	—	16.5(.650)	22.5(.885)	16.5(.650)	11
5~8	24.0(.945)	—	24.5(.965)	30.5(1.200)	24.5(.965)	9

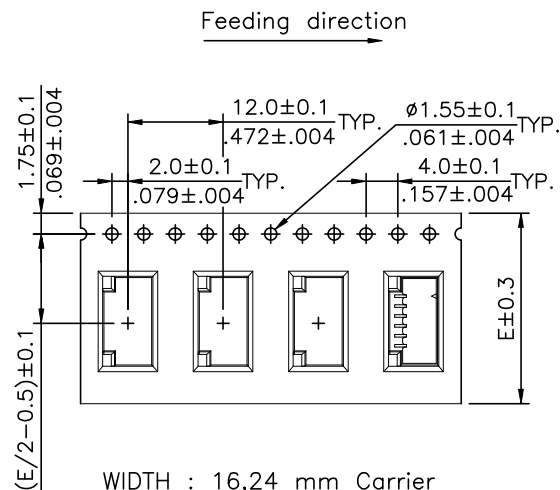
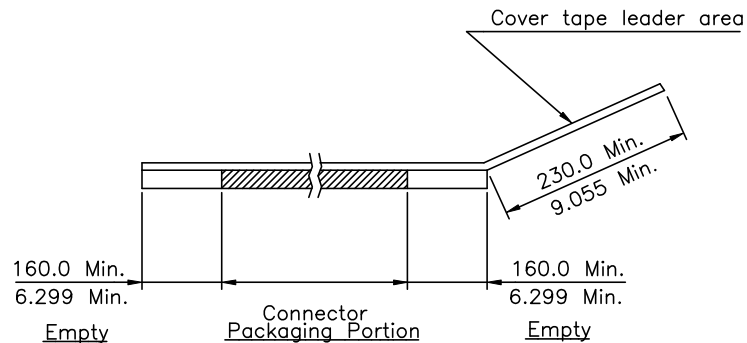

RoHS Compliant

SYM	NAME	DATE	REVISIONS	APPROVED BY:	DATE	UNIT: mm / inch	TITLE: 1.25mm Pitch WTB SMT R/A TYPE	MATERIAL:	FINISH:	SCALE	SHEET 2 OF 2
4					DATE	UNIT: mm / inch	TITLE: 1.25mm Pitch WTB SMT R/A TYPE	MATERIAL:	FINISH:	SCALE	SHEET 2 OF 2
3				DRAWN BY: Jack	12/27-23'	TOLERANCE UNLESS OTHERWISE SPECIFIED					
2				ENGINEER: Sun	12/27-23'	.X ±	X' ± 1'				
1	Jack	12/27-23'	ECNT123179/ECRB123029	CHECKED BY: Eisley	12/27-23'	.XX ±	.X' ±				
				APPROVED BY: Eisley	12/27-23'	.XXX ±	.XX' ±				

XB 东莞市溪榜电子有限公司
Switch Connector DONG GUAN XI BANG ELECTRONI CS CO., LTD.

DRAWING NO. CI4319SB PART NO. CI43**M*HRA-NH
SCALE SHEET 2 OF 2