

Shipping Arrangement: 50 sets per strip
Shipped in carton box

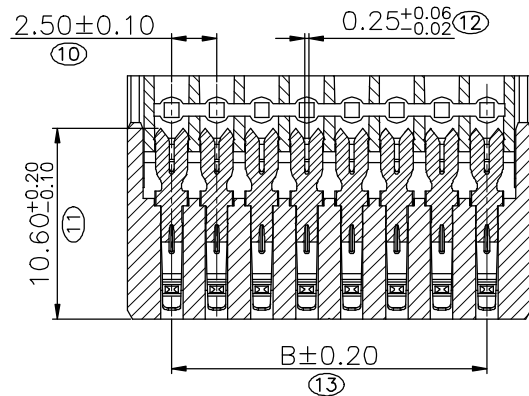

SECTION E-E

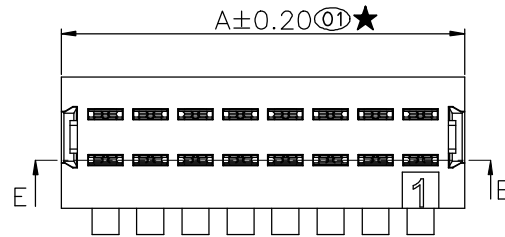
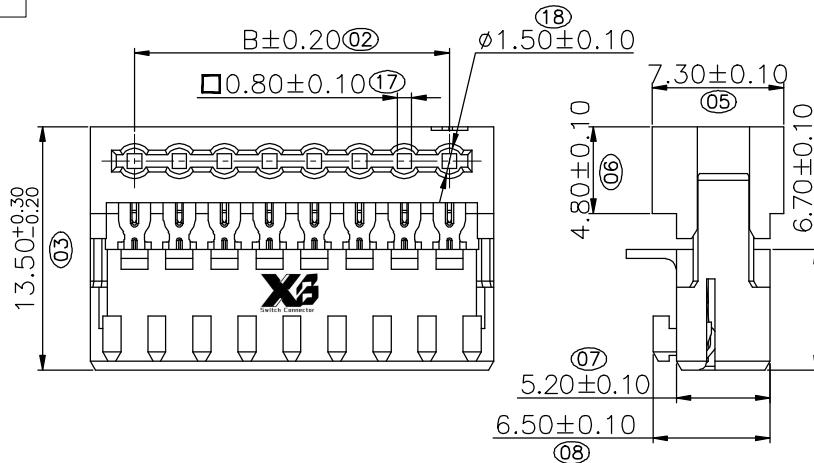

SECTION F-F

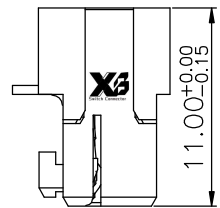

Fully Loaded

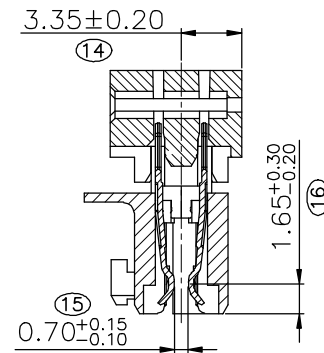
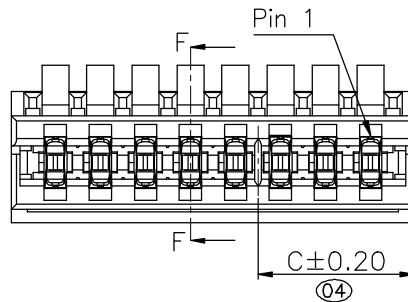

Specifications
Current Rating:2.0Amp.
Insulation Resistance:1000MΩMin.
Dielectric Withstanding Voltage:500VAC.
Contact Resistance:10mΩMax.
Operating Temperature:−40°C to +125°C
Materials.
Contact Material:Phosphor Bronze.
Insulator Material:Thermoplastic,
UL 94V-0 PBT,NYLON 66 or the
equivalent material.

★All materials must meet XI BANG
hazardous substances control standards.
"★": Critical Characteristics
indicates product characteristics,
functionalities, and manufacturing processes
regarding to customer's specifications.
"☆": Safety Features
indicates product characteristics,
functionalities, and manufacturing processes
complying to legal regulations stated by
local government.

Spacer bar	C	D
00		
12	3.70	1.25
23	6.20	3.75
34	8.70	6.25
45	11.20	8.75
56	13.70	11.25
67	16.20	13.75
78	18.70	16.25

Pin NO.	A	B
08	22.40	17.50

XB 东莞市溪榜电子有限公司
DONG GUAN XI BANG ELECTRONICS CO., LTD

REV. 01 UNIT. mm SCALE. 5:2

3RD.ANG
PROJ.
PAGE. 1/2

GENERAL TOLERANCE	
X:±5.0'	X.±0.30
.X'±3.0'	.X±0.25
.XX'±2.0'	.XX±0.15
.XXX'±1.0'	.XXX±0.10

DESIGNED:
CHECKED:
APPROVED:

DATE:
DATE:
DATE:

DWG. NO.
XB-XB-RAST-M-109
PART NO.

TITLE.
RASTLink 2.5mm
Single Row
Female Connector

Ordering Information

XB-XB-RAST-M-109— XX XX A X XX X X AB

No. Of Pins Per Row 08

Standard Plating 05=1u"Gold and 80~160u" Bright tin over 50~100u" Ni underplate overall.

Product form distinguishing serial number A・B・C..... See the following table for specific differences

Spacer bar Code explanation: 00: No keying 12: Keying between pin 1 and pin 2 23: Keying between pin 2 and pin 3 ...and so on (When the pin number is above 10, use the letters A, B, C... A for 10, B for 11... and so on, for example, when the code is AB, it means there is a key between the 10th Pin and the 11th Pin)

Plastic material A=PBT(Halogen) E=NYLON 66(Halogen)

Color 1=Black 4=Natural

PCB layout

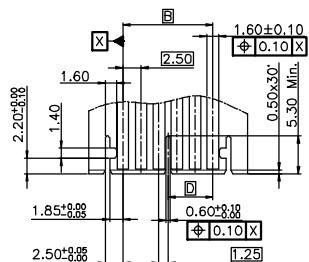

Layout 1:PCBoard 1.50±0.14mm

Product form (buckle)

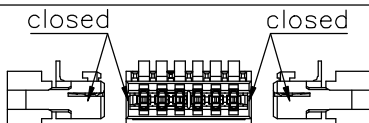

Applicable products:
XB-XB-RAST-M-109-A

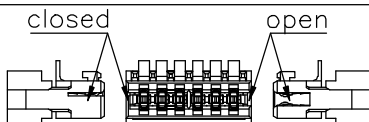

Applicable products:
XB-XB-RAST-M-109-B

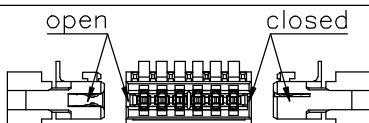

Applicable products:
XB-XB-RAST-M-109-C

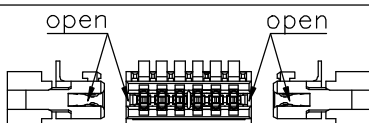

Applicable products:
XB-XB-RAST-M-109-D

PCB layout

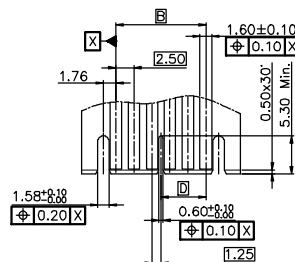

Layout 2:PCBoard 1.50±0.14mm

Product form (without buckle)

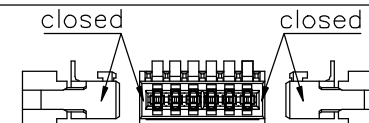

Applicable products:
XB-XB-RAST-M-109-E

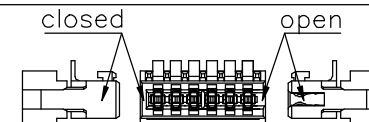

Applicable products:
XB-XB-RAST-M-109-F

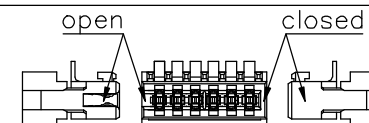

Applicable products:
XB-XB-RAST-M-109-G

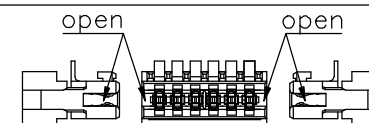

Applicable products:
XB-XB-RAST-M-109-H

东莞市溪榜电子有限公司
DONG GUAN XI BANG ELECTRONICS CO., LTD

REV. 01 UNIT. mm SCALE. 1:1

3RD.ANG
PROJ.

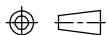

PAGE. 2/2

GENERAL TOLERANCE

X'±5.0'	X±0.30
.X'±3.0'	.X±0.25
.XX'±2.0'	.XX±0.15
.XXX'±1.0'	.XXX±0.10

DESIGNED:

CHECKED:

APPROVED:

DATE:

DATE:

DATE:

DWG. NO.

XB-XB-RAST-M-109

PART NO.

TITLE.

RASTLink 2.5mm
Single Row
Female Connector