

1 2 3 4 5 6 7 8 9

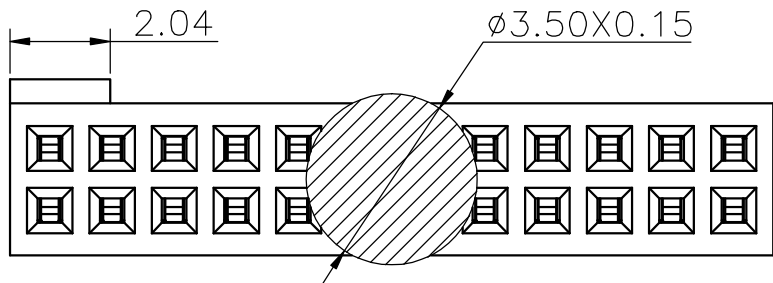

Specifications
 Current Rating:1Amp
 Insulation Resistance:1000MΩMin.
 Dielectric Withstanding Voltage:300VAC
 Contact Resistance:20mΩMax.
 Operating Temperature:-40°C to +105°C
 Materials
 Contact Material:Phosphor Bronze
 Insulator Material:High Temperature Thermoplastic, UL 94V-0 LCP or the equivalent material
 All materials must meet XI BANG requirement for environment protection.

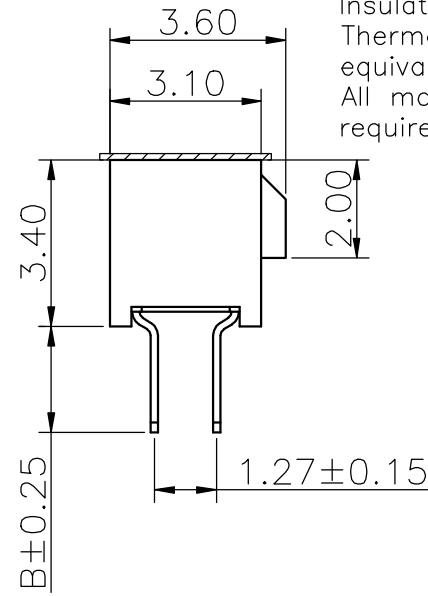
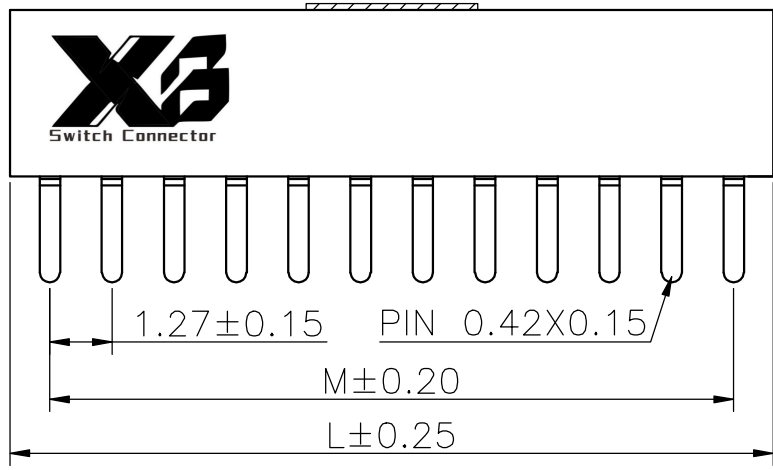

Recommended P.C.Board Layout
 (Tolerance:±0.05)

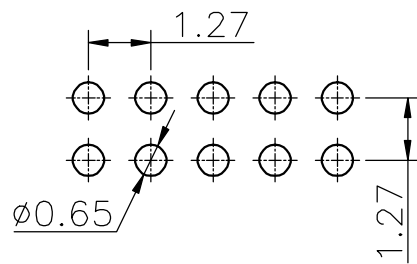

No. of PIN/ROW	Dimension Information	
	M	L
03	2.54	4.16
04	3.81	5.43
05	5.08	6.70
06	6.35	7.97
07	7.62	9.24
08	8.89	10.51
09	10.16	11.78
10	11.43	13.05
11	12.70	14.32
12	13.97	15.59
13	15.24	16.86
14	16.51	18.13
15	17.78	19.40
16	19.05	20.67
17	20.32	21.94
18	21.59	23.21
19	22.86	24.48
20	24.13	25.75
21	25.40	27.02
22	26.67	28.29
23	27.94	29.56
24	29.21	30.83
25	30.48	32.10
26	31.75	33.37
27	33.02	34.64
28	34.29	35.91
29	35.56	37.18
30	36.83	38.45
31	38.10	39.72
32	39.37	40.99
33	40.64	42.26
34	41.91	43.53
35	43.18	44.80
36	44.45	46.07
37	45.72	47.34
38	46.99	48.61
39	48.26	49.88
40	49.53	51.15
41	50.80	52.42
42	52.07	53.69
43	53.34	54.96
44	54.61	56.23
45	55.88	57.50
46	57.15	58.77
47	58.42	60.04
48	59.69	61.31
49	60.96	62.58
50	62.23	63.85

Ordering Information

230 - XX XX A XXX C
 Plastic specifications: 1=Single row, 2=Dual row, 3=Tripe row, 4=Quadruple
 Water code: No. of Pins per Row 03~50
 Positioning column information: A=No locating post, B=Round post, C=Square post
 Pin length: See the drawing
 Plating code: 01=Tin, 02=Gold Flash, 05=Gold Flash/Tin, 22=Matte Tin
 Insulator Material: C=LCP
 Color: 1=Black, 2=White, 3=Yellow, E=Beige
 Packing code: C=Tube, D=Tape&Reel, E=Cap+Tube, F=Cap+Tape&Reel, G=Acetate Tape+Tube, H=Acetate Tape+Tape&Reel
 Contact Material: A/S/K/T=Phosphor Bronze

GENERAL TOLERANCE	
X.*±5.0'	X.±0.30
.X'±3.0'	.X±0.25
.XX'±2.0'	.XX±0.15
.XXX'±1.0'	.XXX±0.10

DESIGN:	DATE:	DWG. NO.	TITLE.
CHECKED:	DATE:	XB-PM-A-127-230	
AUDITED:	DATE:	PART NO.	
APPROVED:	DATE:		

1.27 FEMALE HEADER
 DUAL ROW DIP TYPE

XB 东莞市溪榜电子有限公司
 DONG GUAN XI BANG ELECTRONICS CO., LTD.
 REV. 01 UNIT. mm SCALE. 4:1 PAGE. 1/1

1 2 3 4 5 6 7 8 9