

ROHS

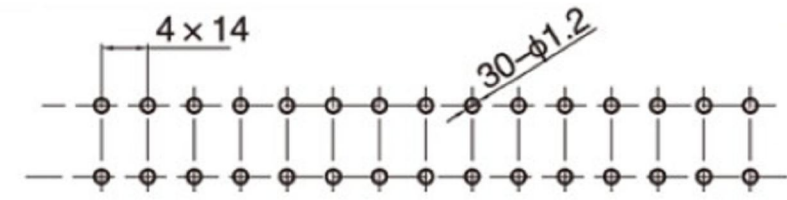

PCB LAYOUT

SCHEMATIC

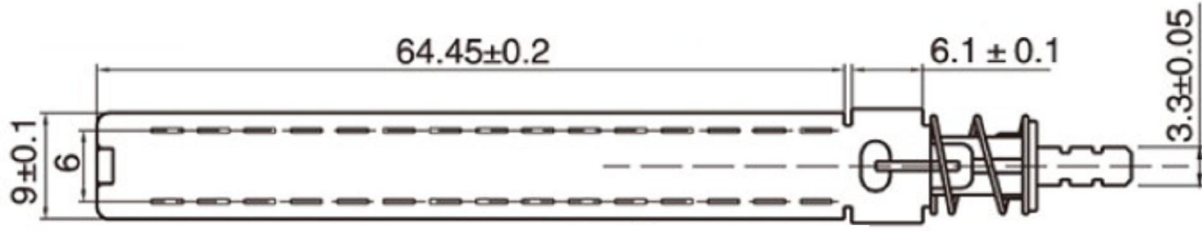
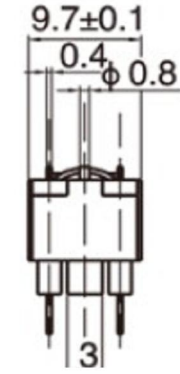
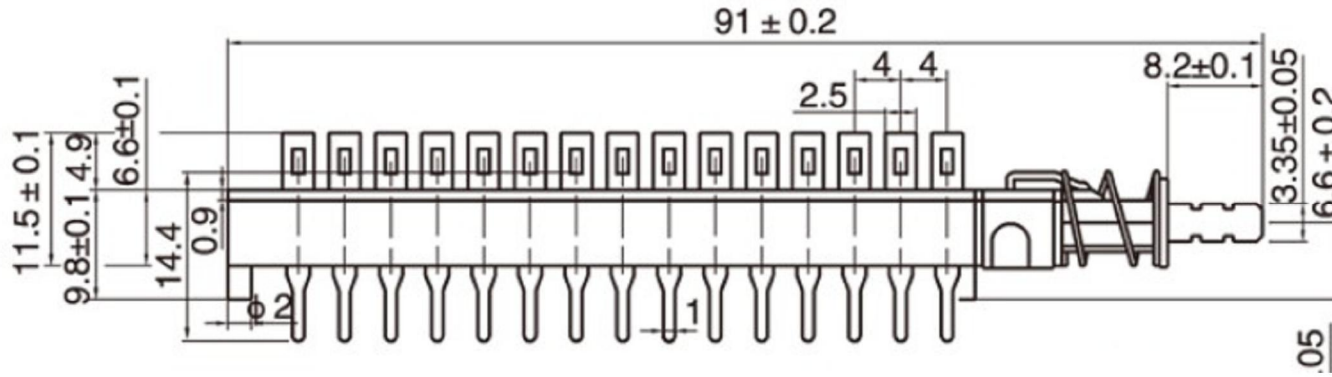
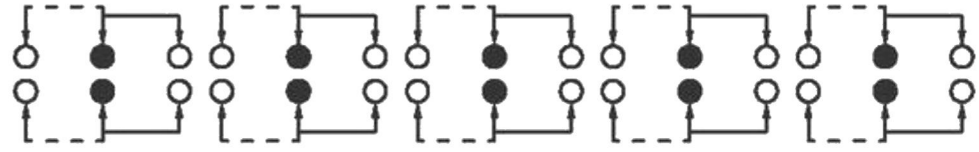

ITEM: PERFORMANCE
 Title: PUSH BUTTOMN SWICH
 Model: XB-PBS-Z10-2
 Rating: 0.3A 0.5A 12V 30V DC
 Function: 10P2T
 Timing:Non-shorting
 ContactResistance(mohms):50mΩ max
 Insulation Resistanc(Mohms):100MΩ min at 500V DC
 Dielectric Strength(V):AC 500V for 1 min
 LifeTest:10,000 Cycles



东莞市溪榜电子有限公司
 DONG GUAN XI BANG ELECTRONICS CO., LTD

TITLE : XB PUHS BUTTON SWITCH
 MODEL : XB-PBS-Z10-2 琴键开关双排30PIN 10路2组

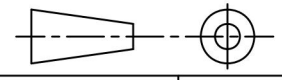

UNIT : MM	DWN.	ZENQ. CHEN	DATE	2024-05-08	TOLERANCE <=1.5mm ± 0.1 >1.5mm ± 0.2 >=10mm ± 0.3	ANGLE ± 2°
SCALE : 3 : 1	CHK'D	PANG. DONG	DATE	2024-05-08		
VERSION	01	APPD.	FEI. LONG. HE	DATE		

8	CONTACT CLIP	PBS STRIP	2	Ag CLAD
7	RING	IRON STRIP	1	Zn PLATED
6	SPRING	SUS	1	NATURE
5	SLEEVE	POM	1	GRAY
4	CASE	NYLON	1	GRAY
3	COVER	PBT	1	GRAY
2	TERMINAL	BRASS STRIP	6	Ag PLATED
1	KNOB	POM	1	YELLOW
NO.	PART NAME	MATERIAL	QTY.	FINISHING