

1 2 3 4 5 6 7 8 9

F

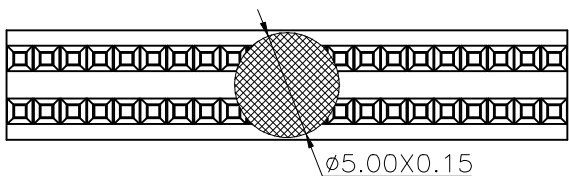

E

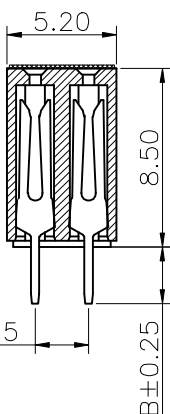

D

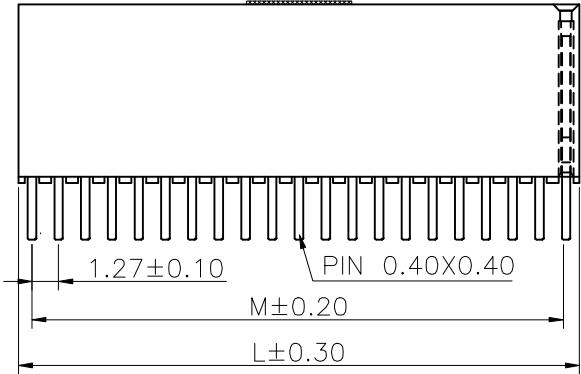

C

Recommended P.C.Board
Layout
(Tolerance:±0.05)

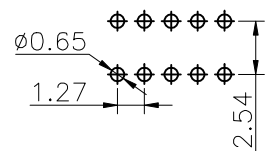

Specifications
Current Rating:1Amp
Insulation Resistance:1000MΩMin.
Dielectric Withstanding Voltage:300VAC
Contact Resistance:20mΩMax.
Operating Temperature:−40°C to +105°C
Materials
Contact Material:Phosphor Bronze
Insulator Material:High Temperature Thermoplastic, UL 94V−0 LCP or the equivalent material
All materials must meet Greenconn requirement for environment protection.

No. of PIN/ROW	Dimension Information	
	M	L
02	1.27	2.54
03	2.54	3.81
04	3.81	5.08
05	5.08	6.35
06	6.35	7.62
07	7.62	8.89
08	8.89	10.16
09	10.16	11.43
10	11.43	12.70
11	12.70	13.97
12	13.97	15.24
13	15.24	16.51
14	16.51	17.78
15	17.78	19.05
16	19.05	20.32
17	20.32	21.59
18	21.59	22.86
19	22.86	24.13
20	24.13	25.40
21	25.40	26.67
22	26.67	27.94
23	27.94	29.21
24	29.21	30.48
25	30.48	31.75
26	31.75	33.02
27	33.02	34.29
28	34.29	35.56
29	35.56	36.83
30	36.83	38.10
31	38.10	39.37
32	39.37	40.64
33	40.64	41.91
34	41.91	43.18
35	43.18	44.45

Ordering Information

XB-PM-A-127-213

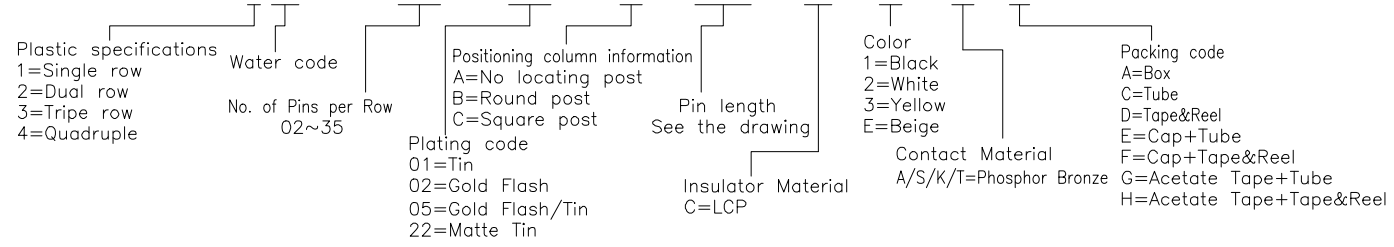

B

A

XB 东莞市溪榜电子有限公司
Switch Connector DONG GUAN XI BANG ELECTRONICS CO., LTD.

GENERAL TOLERANCE	
X'±5.0'	X.±0.30
.X'±3.0'	.X±0.25
.XX'±2.0'	.XX±0.15
.XXX'±1.0'	.XXX±0.10

DESIGN:	DATE:
CHECKED:	DATE:
AUDITED:	DATE:
APPROVED:	DATE:

DWG. NO.
XB-PM-A-127-213
PART NO.
XB-PM-A-127-213

TITLE:
1.27 FEMALE HEADER
DUAL ROWS DIP TYPE
CONNECTOR

1 2 3 4 5 6 7 8 9

Specifications

Current Rating : 1.0 Ampere
 Insulation Resistance : 1000 MΩ Min
 Dielectric Withstanding : 300V AC
 Contact Resistance : 20 mΩ Max
 Operating Temperature : -40°C to +105°C

Materials

Contact Material : Phosphor Bronze
 Insulation Material : High Temperature Thermoplastic, 94V-0 LCP

All materials must meet Greenconn's requirements for environmental protection.

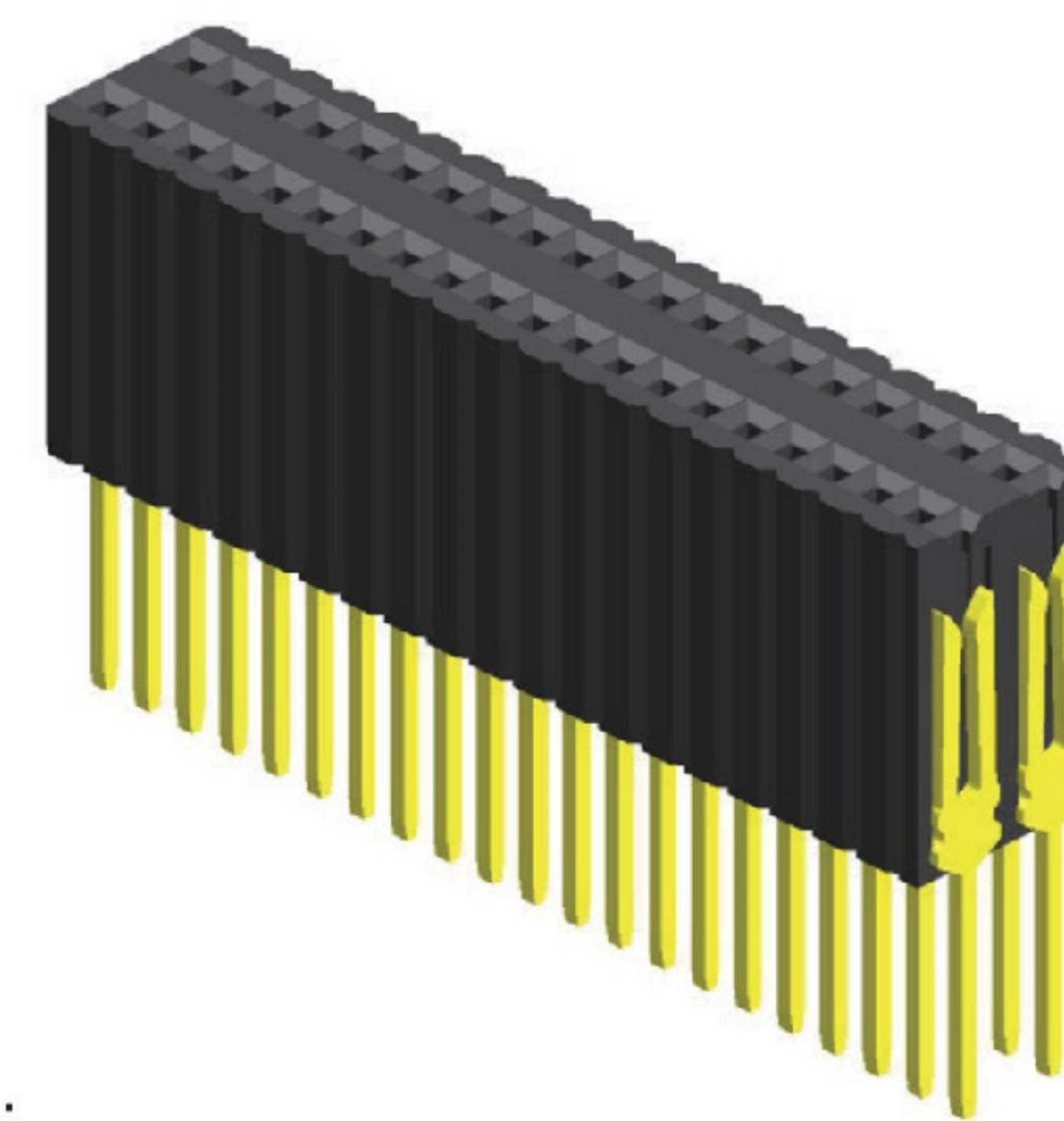

Mating with

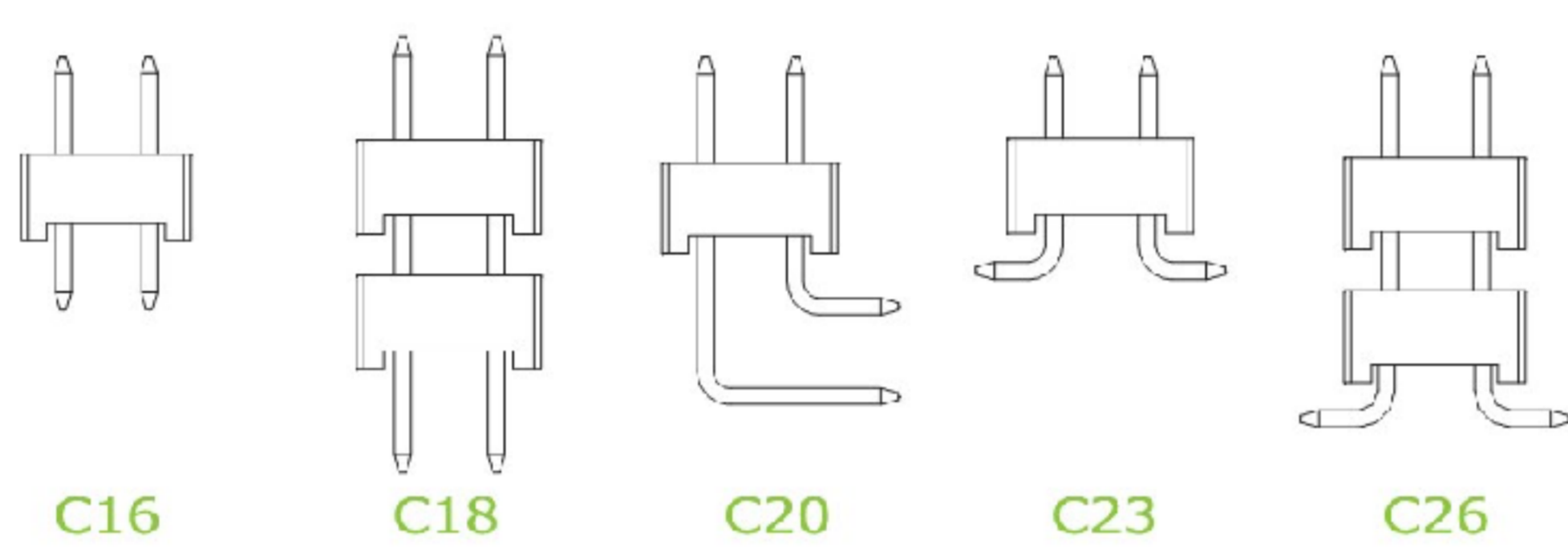

P.S. : Suggested mating pin length : 3.5 ~ 6.4 mm

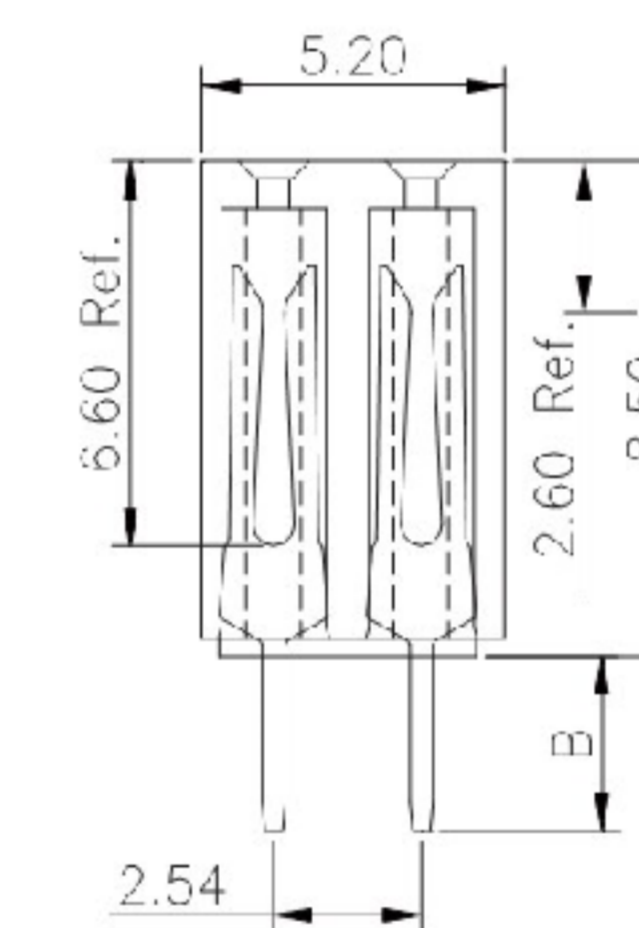
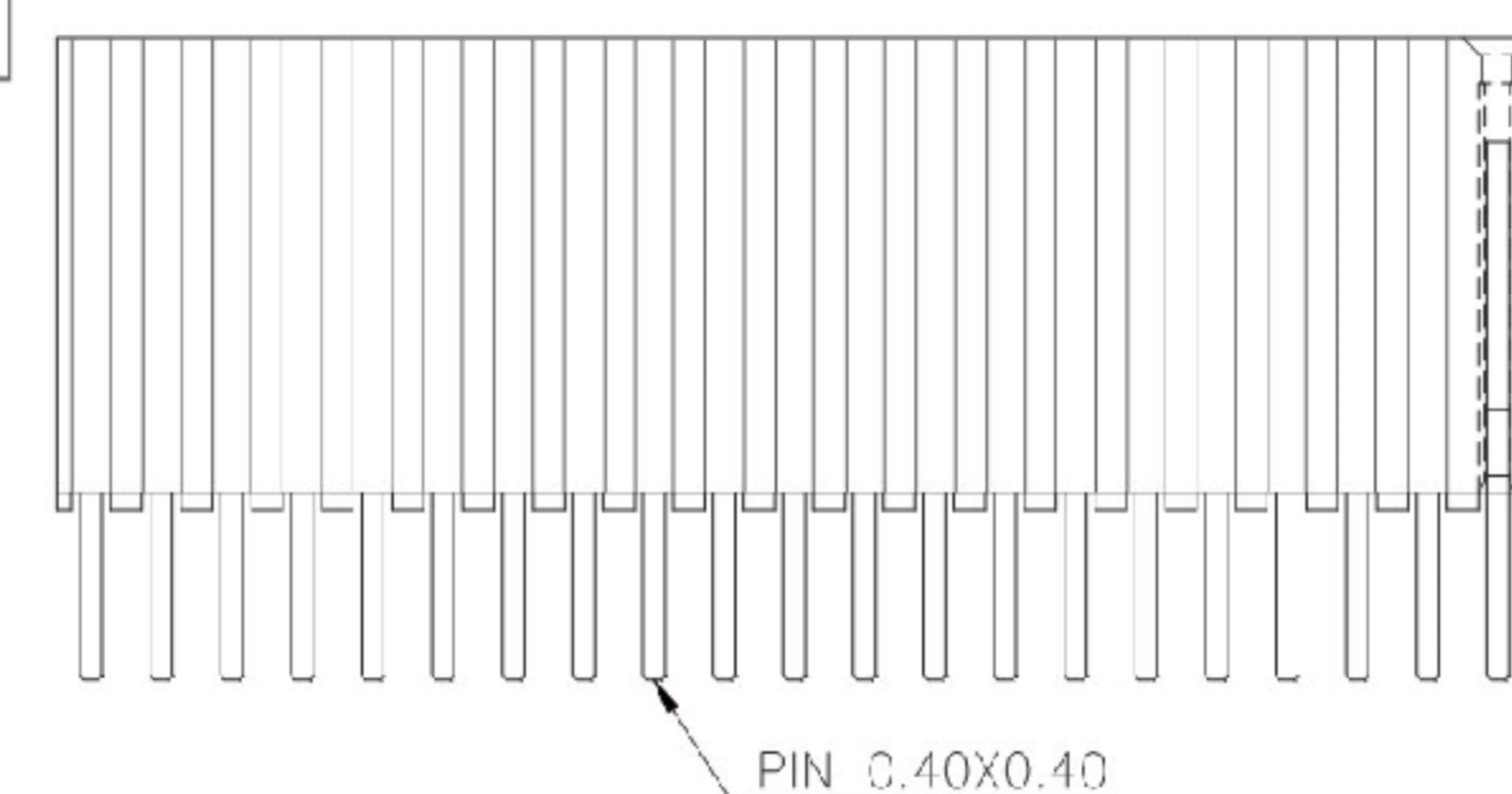
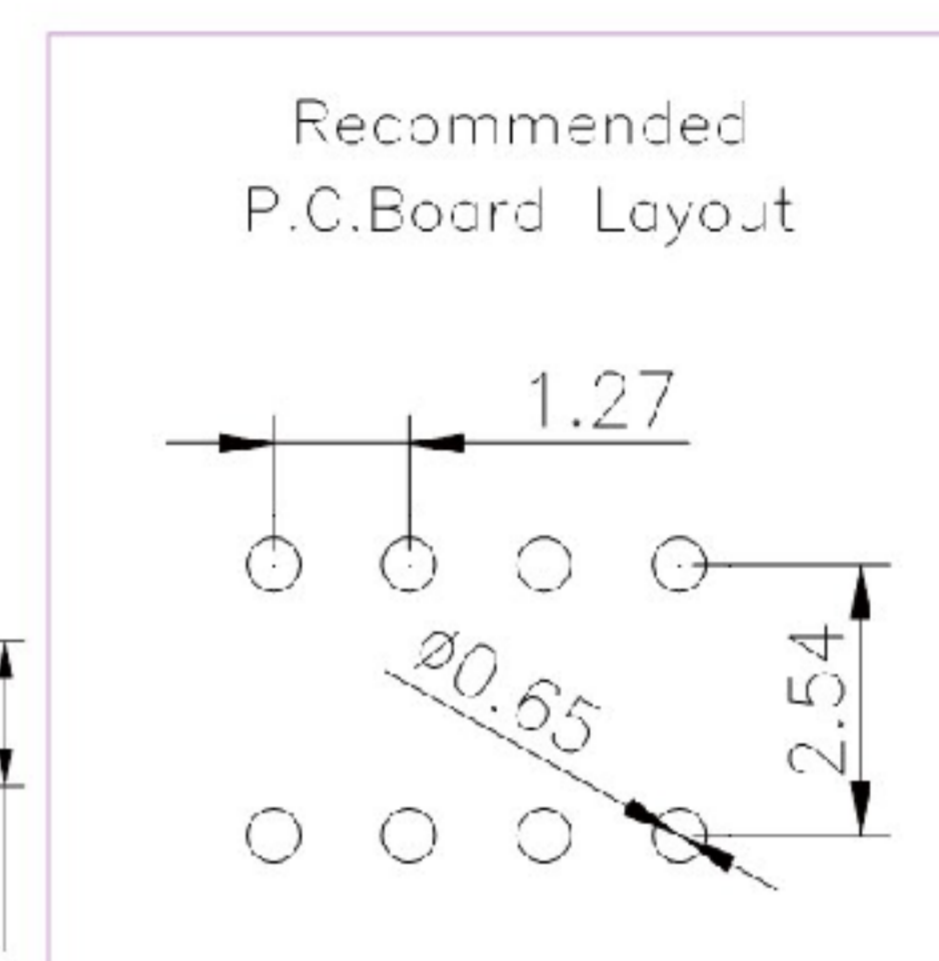
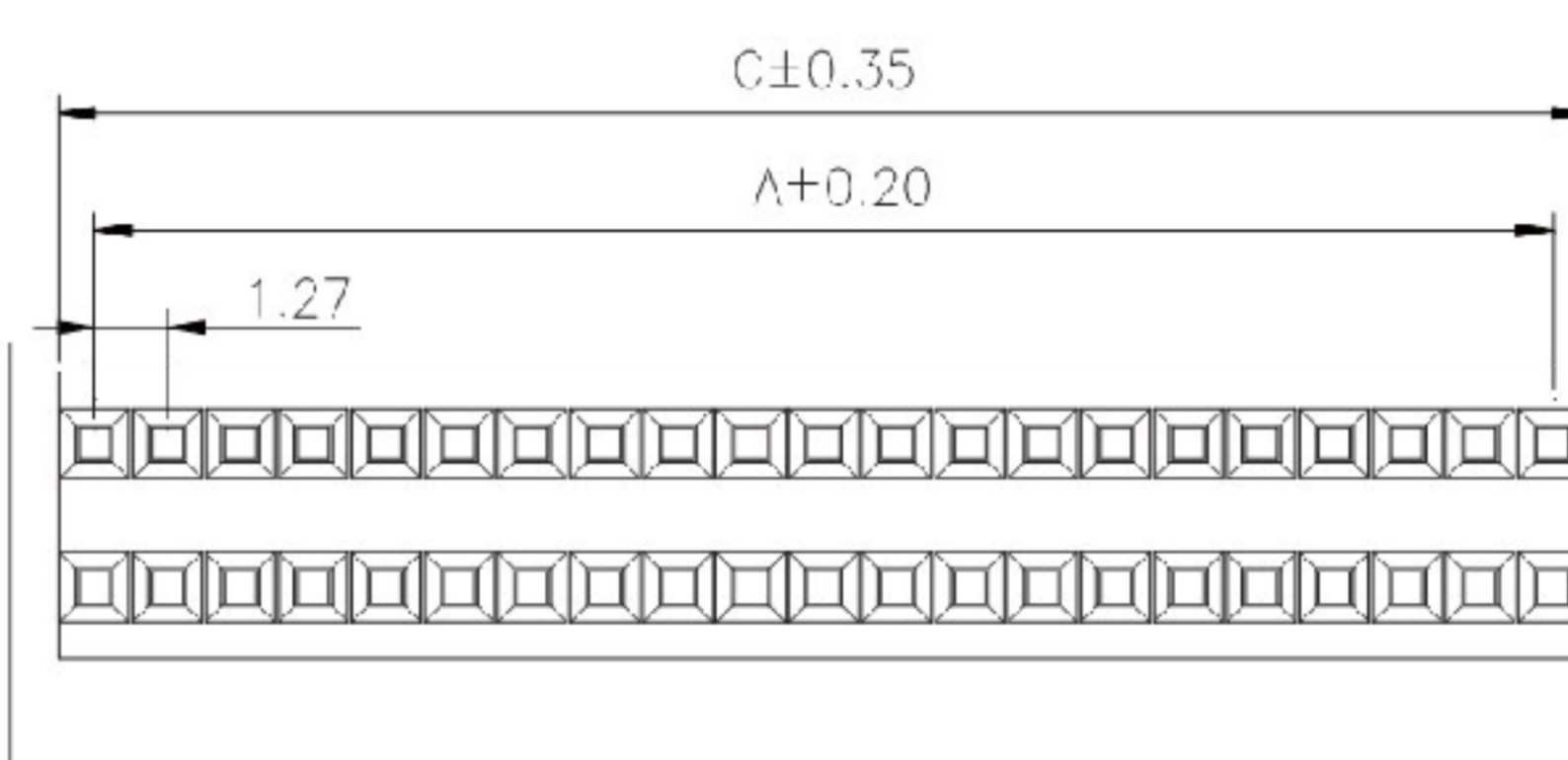

* For Coded Dimension Not Inside The Table, Please Refer To "Ordering Information"

No. of Pins/Row	Dimension Information		No. of Pins/Row	Dimension Information		No. of Pins/Row	Dimension Information		No. of Pins/Row	Dimension Information	
	A	C		A	C		A	C		A	C
02	1.27	2.54	11	12.70	13.97	21	25.40	26.67	31	38.10	39.37
03	2.54	3.81	12	13.97	15.24	22	26.67	27.94	32	39.37	40.64
04	3.81	5.08	13	15.24	16.51	23	27.94	29.21	33	40.64	41.91
05	5.08	6.35	14	16.51	17.78	24	29.21	30.48	34	41.91	43.18
06	6.35	7.62	15	17.78	19.05	25	30.48	31.75	35	43.18	44.45
07	7.62	8.89	16	19.05	20.32	26	31.75	33.02			
08	8.89	10.16	17	20.32	21.59	27	33.02	34.29			
09	10.16	11.43	18	21.59	22.86	28	34.29	35.56			
10	11.43	12.70	19	22.86	24.13	29	35.56	36.83			
			20	24.13	25.40	30	36.83	38.10			

XB 东莞市溪榜电子有限公司
 DONG GUAN XI BANG ELECTRONICS CO., LTD.

REV. 01 UNIT. mm SCALE. 5:1 PAGE. 1/1

GENERAL TOLERANCE	
X' ± 5.0'	X ± 0.30
.X' ± 3.0'	.X ± 0.25
.XX' ± 2.0'	.XX ± 0.15
.XXX' ± 1.0'	.XXX ± 0.10

DESIGN: _____ DATE: _____
 CHECKED: _____ DATE: _____
 AUDITED: _____ DATE: _____
 APPROVED: _____ DATE: _____

DWG. NO. XB-PM-A-127-213
 PART NO. XB-PM-A-127-213

TITLE. 2.00 FEMALE HEADER
 SINGLE ROW DIP TYPE
 BASE 4.30H