

8PIN

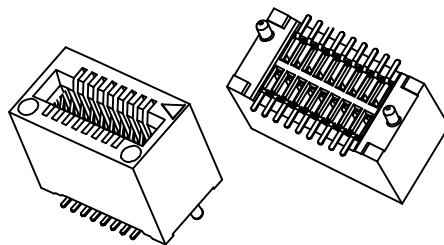

Specifications
 Current Rating:1.0Amp
 Insulation Resistance:1000MΩMin.
 Dielectric Withstanding Voltage:300VAC
 Contact Resistance:20mΩMax.
 Operating Temperature:-40°C to +105°C
 Materials
 Contact Material:Phosphor Bronze
 Insulator Material:High Temperature Thermoplastic, UL 94V-0 LCP or the equivalent material
 All materials must meet GREENCONN hazardous substances control standards.

Recommended P.C.Board Layout
 (Tolerance:±0.05)

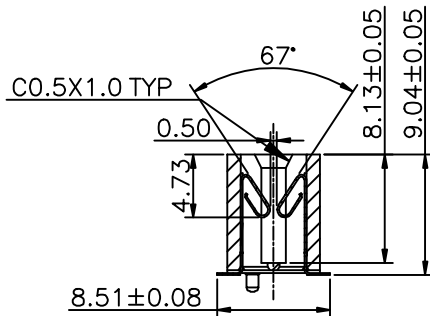
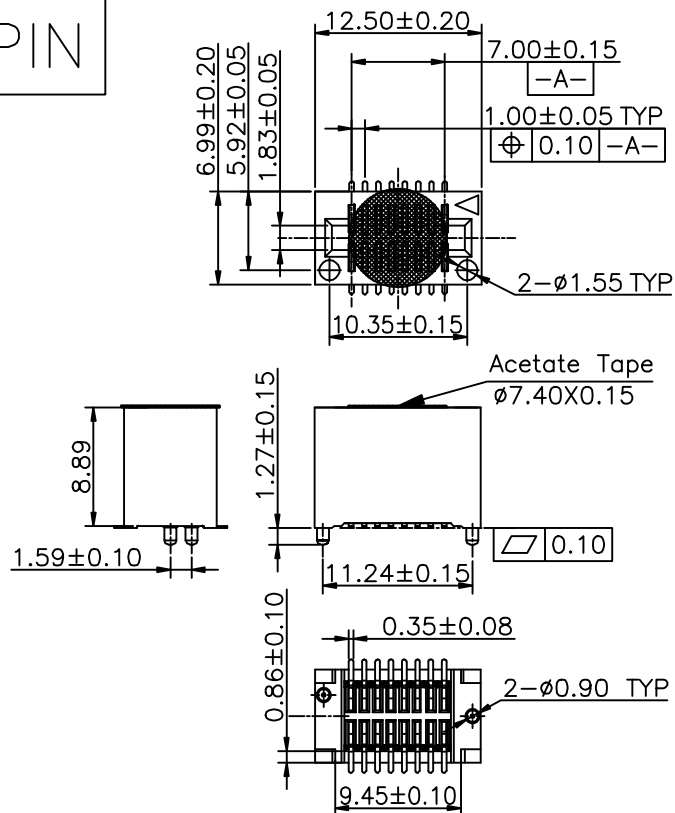
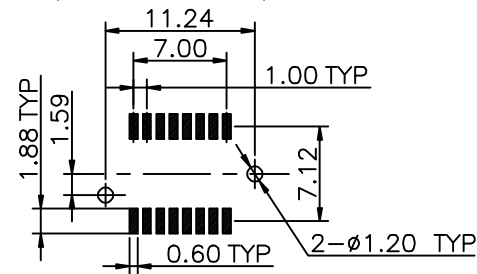

Ordering Information
 XB-CSCC-215

No. of Pins per Row
 08

Standard Plating
 02=Gold Flash
 Selective Plating
 01=Tin
 05=Gold Flash/Tin
 45=10u" Gold on conatct point ,
 Matte Tin on tail(Matte Tin 80~160u")

Color
 1=Black

Standard Packing
 C=Tube
 Selective Packing
 A=Box
 G=Acetate Tape+Tube
 H=Acetate Tape+Tape&Reel
 D=Tape&Reel

东莞市溪榜电子有限公司
 DONG GUAN XI BANG ELECTRONICS CO., LTD.

REV. 01 UNIT. mm SCALE. 2:1 PAGE. 1/1

GENERAL TOLERANCE	
X.'±5.0'	X.±0.30
.X'±3.0'	.X±0.25
.XX'±2.0'	.XX±0.15
.XXX'±1.0'	.XXX±0.10

DESIGNED:	DATE:
CHECKED:	DATE:
CO SIGNED:	DATE:
APPROVED:	DATE:

DWG. NO.	XB-CSCC-215
PART NO.	XB-CSCC-215

TITLE.
 1.00 FEMALE HEADER
 DAUL ROWS SMT TYPE
 CONNECTOR

20PIN

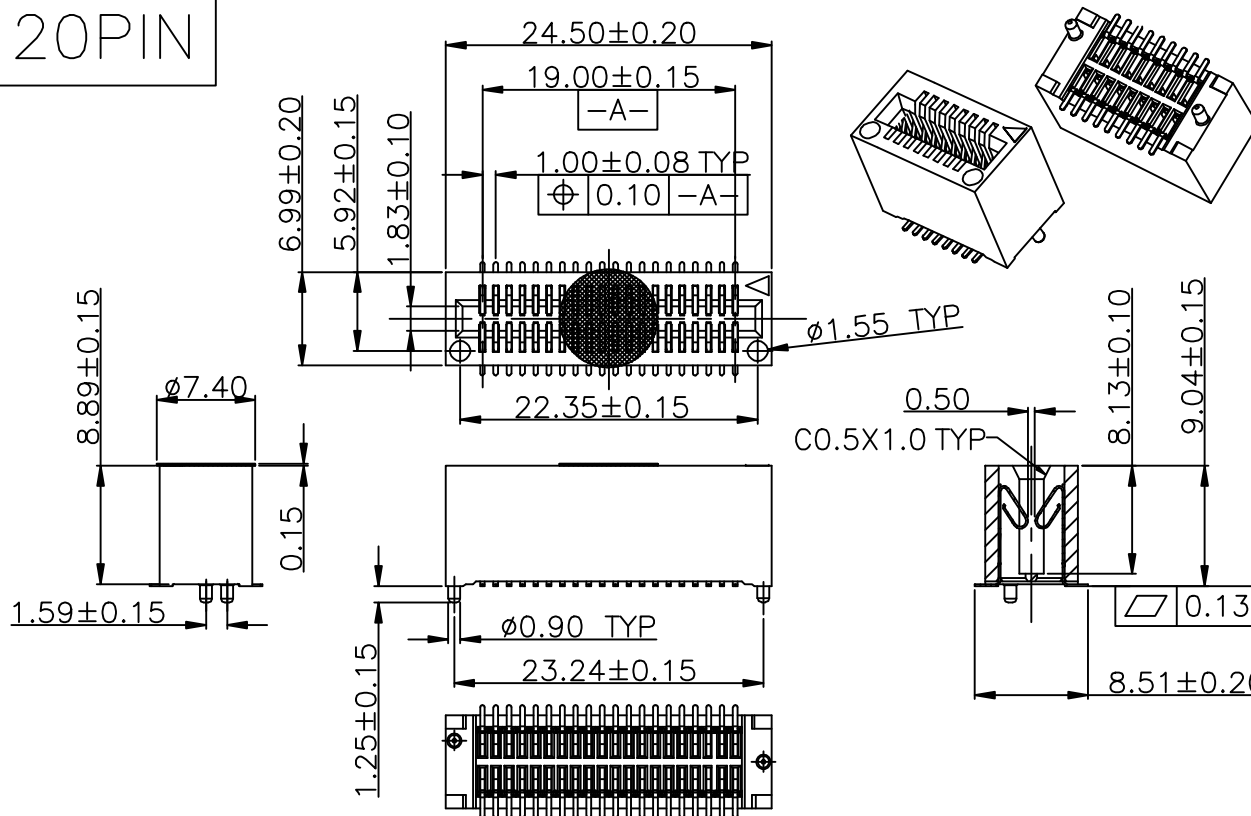

Specifications
 Current Rating:1.0Amp
 Insulation Resistance:1000MΩMin.
 Dielectric Withstanding Voltage:300VAC
 Contact Resistance:20mΩMax.
 Operating Temperature:-40°C to +105°C
 Materials
 Contact Material:Phosphor Bronze
 Insulator Material:High Temperature Thermoplastic, UL 94V-0 LCP or the equivalent material
 All materials must meet GREENCONN hazardous substances control standards.

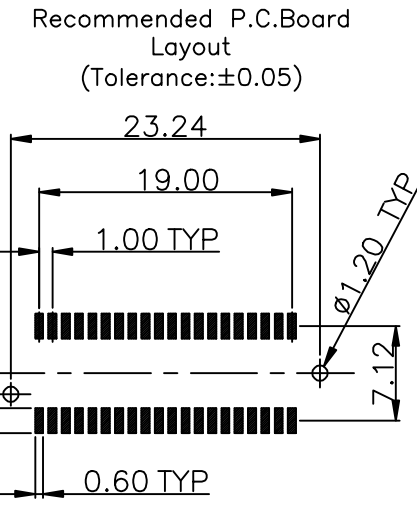
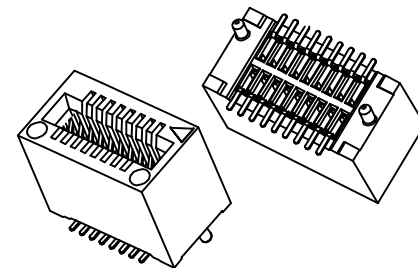

Ordering Information

C SCC215 - 20 XX B 001 C 1 A X

No. of Pins per Row 20
 Standard Plating
 02=Gold Flash
 Selective Plating
 01=Tin
 05=Gold Flash/Tin
 45=10u" Gold on conatct point ,
 Matte Tin on tail(Matte Tin 80~160u")
 Color 1=Black
 Standard Packing
 C=Tube
 Selective Packing
 A=Box
 G=Acetate Tape+Tube
 H=Acetate Tape+Tape&Reel
 D=Tape&Reel

东莞市溪榜电子有限公司
 DONG GUAN XI BANG ELECTRONICS CO., LTD.
 Switch Connector

REV.	UNIT.	SCALE.	PAGE.
01	mm	2:1	1/1

GENERAL TOLERANCE	
X.'±5.0'	X.±0.30
.X'±3.0'	.X±0.25
.XX'±2.0'	.XX±0.15
.XXX'±1.0'	.XXX±0.10

DESIGNED:	DATE:
CHECKED:	DATE:
CO SIGNED:	DATE:
APPROVED:	DATE:

DWG. NO.
 CSCC215-CB1CA
 PART NO.
 CSCC215-20XX B001C1AX

TITLE.
 1.00 FEMALE HEADER
 DAUL ROWS SMT TYPE
 CONNECTOR

30PIN

Specifications
 Current Rating:1.0Amp
 Insulation Resistance:1000MΩMin.
 Dielectric Withstanding Voltage:300VAC
 Contact Resistance:20mΩMax.
 Operating Temperature:-40°C to +105°C
 Materials
 Contact Material:Phosphor Bronze
 Insulator Material:High Temperature Thermoplastic, UL 94V-0 LCP or the equivalent material
 All materials must meet GREENCONN hazardous substances control standards.

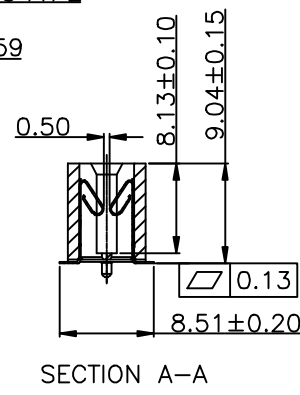
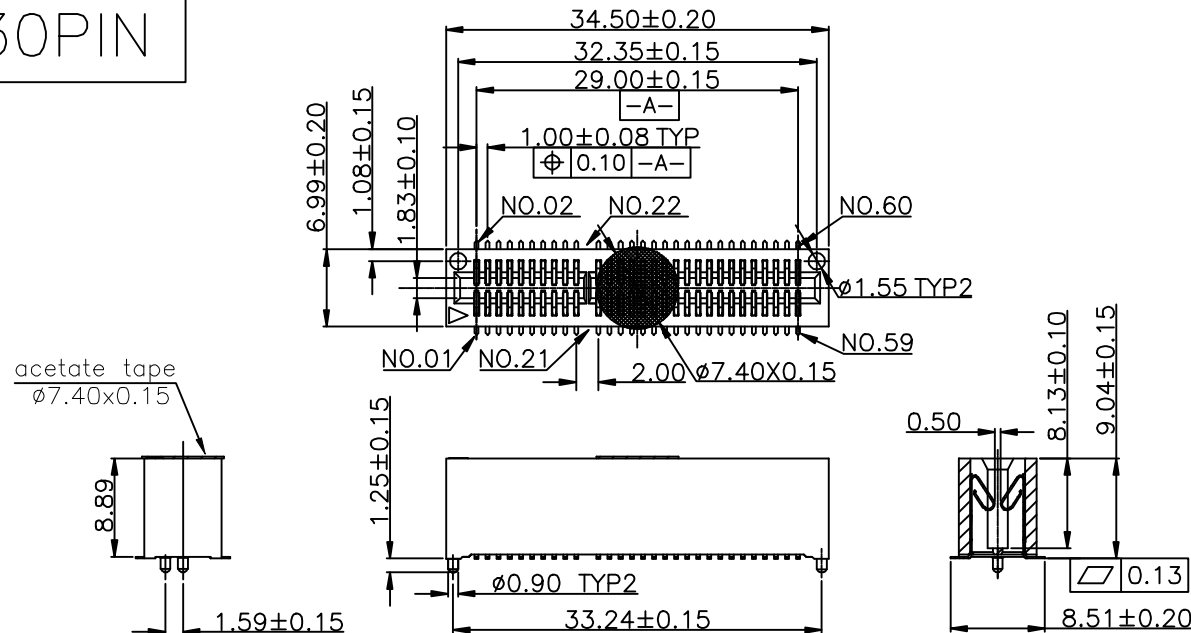

Recommended P.C.Board Layout
 (Tolerance:±0.05)

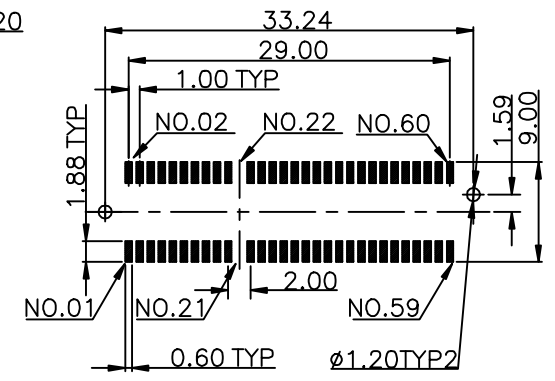

Ordering Information

C SCC215 - 30 XX B 001 C X S X

No. of Pins per Row: 30
 Standard Plating: 01=Tin
 Selective Plating: 45=10u"Au/80u"~160u"Matte Tin
 Color: 1=Black
 Standard Packing: C=Tube
 Selective Packing: G=acetate tape +Tube, H=acetate tape +Tape&Reel

东莞市溪榜电子有限公司
 DONG GUAN XI BANG ELECTRONICS CO., LTD.
 Switch Connector

REV. 01 UNIT. mm SCALE. 5:3 PAGE. 1/1

GENERAL TOLERANCE	
X.'±3.0'	X.±0.25
.X'±2.0'	.X±0.20
.XX'±1.0'	.XX±0.13
.XXX'±0.5'	.XXX±0.08

DESIGNED:	DATE:
CHECKED:	DATE:
CO SIGNED:	DATE:
APPROVED:	DATE:

DWG. NO.	CSCC215-CB1CS
PART NO.	CSCC215-30XXB001C1SX

TITLE.	Pitch 1.00 Fmale Connector MINI PCI 30PIN SMT TYPE
--------	--

49PIN

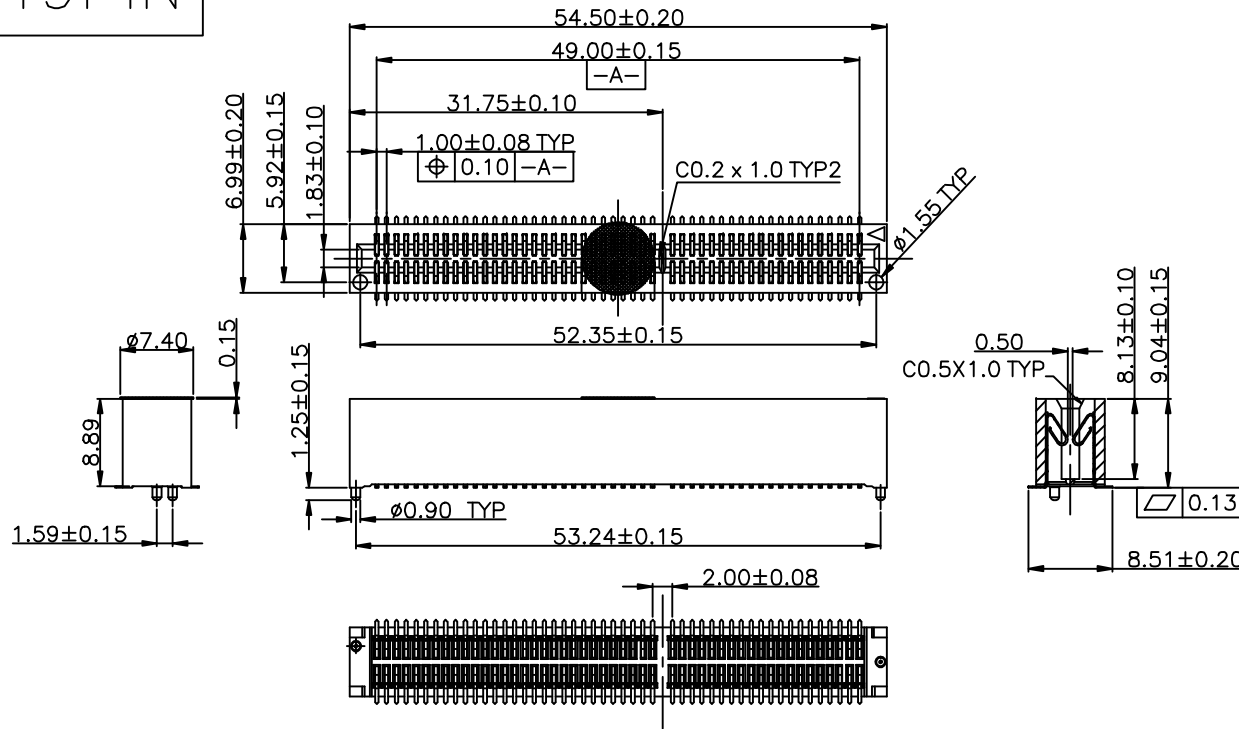

Specifications
 Current Rating: 1.0Amp
 Insulation Resistance: 1000MΩMin.
 Dielectric Withstanding Voltage: 300VAC
 Contact Resistance: 20mΩMax.
 Operating Temperature: -40°C to +105°C
 Materials
 Contact Material: Phosphor Bronze
 Insulator Material: High Temperature Thermoplastic, UL 94V-0 LCP or the equivalent material
 All materials must meet GREENCONN hazardous substances control standards.

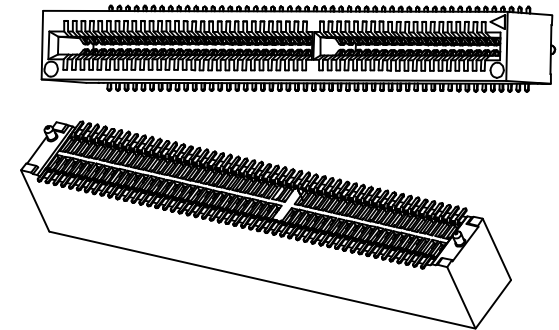

Recommended P.C.Board Layout
 (Tolerance: ± 0.05)

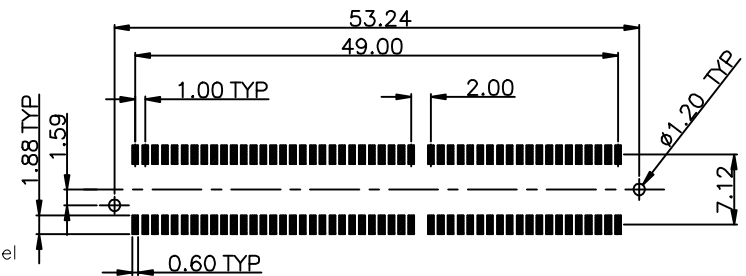

Ordering Information

C SCC215 - 49 XX B 001 C 1 A X

No. of Pins per Row: 49

Standard Plating: 02=Gold Flash, Selective Plating, 01=Tin, 05=Gold Flash/Tin, 45=10u" Gold on contact point, Matte Tin on tail (Matte Tin 80~160u")

Color: 1=Black

Standard Packing: C=Tube, Selective Packing, A=Box, G=Acetate Tape+Tube, H=Acetate Tape+Tape&Reel, D=Tape&Reel

东莞市溪榜电子有限公司
 DONG GUAN XI BANG ELECTRONICS CO., LTD.

REV. 01 UNIT. mm SCALE. 2:1 PAGE. 1/1

GENERAL TOLERANCE	
X.' $\pm 5.0'$	X. ± 0.30
.X' $\pm 3.0'$.X ± 0.25
.XX' $\pm 2.0'$.XX ± 0.15
.XXX' $\pm 1.0'$.XXX ± 0.10

DESIGNED:	DATE:
CHECKED:	DATE:
CO SIGNED:	DATE:
APPROVED:	DATE:

DWG. NO.	CSSC215-CB1CA
PART NO.	CSSC215-49XX B001C1AX

TITLE:
 1.00 FEMALE HEADER
 DAUL ROWS SMT TYPE
 CONNECTOR