

ROHS

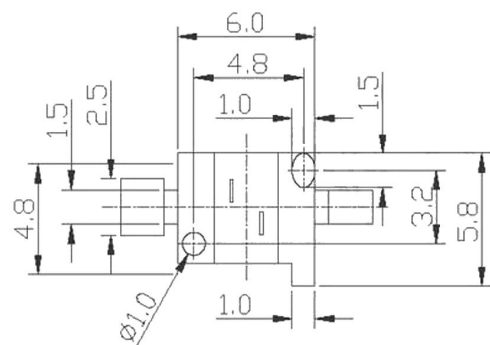

SCHEMATIC

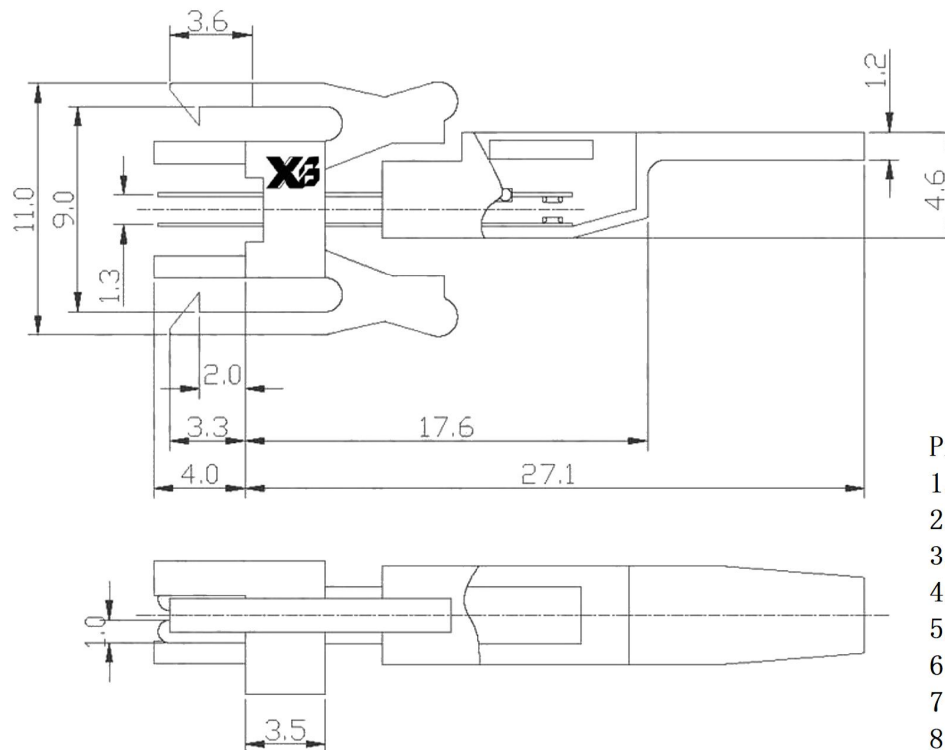
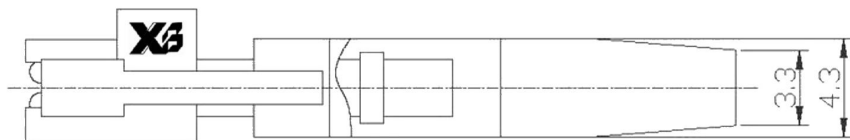

Product material

1. Blade switch
2. Base: POM/PA66
3. Terminal: Phosphorus copper
4. Contact point: Purple copper
5. Electroplating: Silver/Gold Plating
6. Temperature range for use: $-10\text{ }^{\circ}\text{C} \pm 60\text{ }^{\circ}\text{C}$
7. Current and voltage: 0.5A 12V DC
8. Operating force: 30GF \pm 10GF
9. Voltage withstand: 500V 0.5mA/min
10. Insulation resistance: 100M Ω
11. Contact resistance: 30M Ω
12. Lifetime: 50000 times

The material contained in this drawing is the property of XiBang. Any use other than that specifically authorized by XiBang is prohibited. The above drawing IS subjected to change for improvement without prior notice.



Switch Connector

东莞市溪榜电子有限公司

DONG GUAN XI BANG ELECTRONICS CO.,LTD

TITLE : LF LEAF SWITCH

MODEL : LF-1731



TOLERANCE

ANGLE

$\leq 5\text{mm } \pm 0.1$
 $> 5\text{mm } \pm 0.2$

$\pm 2^{\circ}$

UNIT : MM

DWN.

DATE

SCALE : 3 : 1

CHK'D

DATE

VERSION 01

APPD.

DATE

4	CONTACT POINT	BRASS	2	Ag PLATED
3	CASE	POM	1	BLACK
2	CONTACT	PBS STRIP	2	Ag PLATED
1	COVER	PC	1	CLEAR
NO.	PART NAME	MATERIAL	QTY.	FINISHING