

CAD FILE:

IP67

ROHS

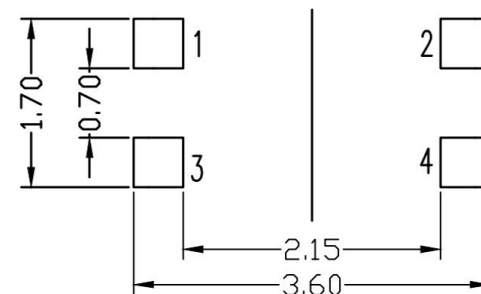
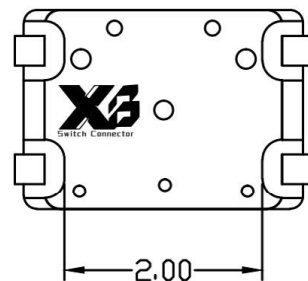
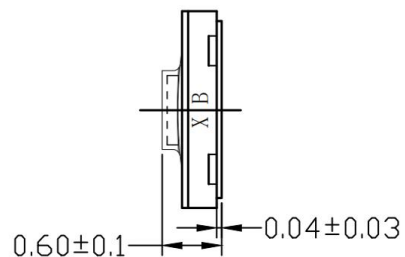
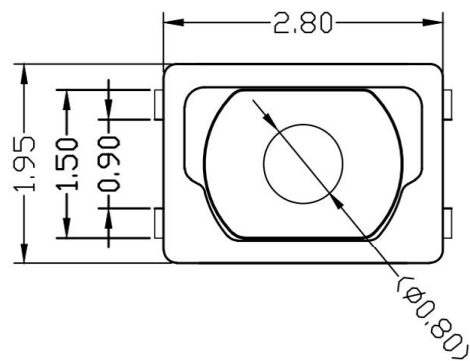

Recommended PAD Layout $\Phi \pm 0.05$

Recommended solder thickness: T=0.10±0.01

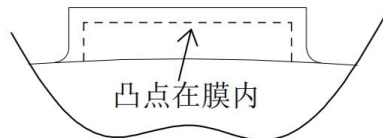
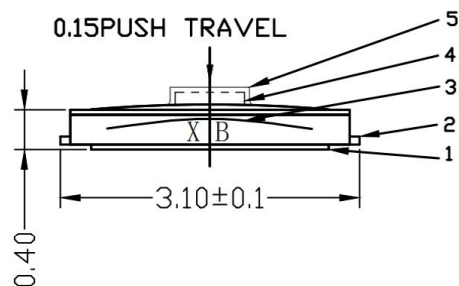

TEASCALE: 2.5/1

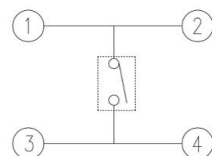

CIRCUIT DIAGRAM

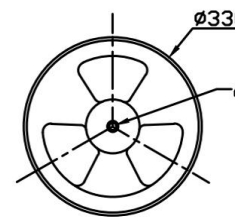

SC 1:150

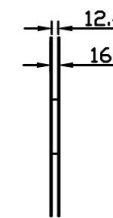

SC 1:10

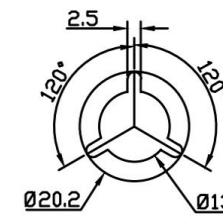

DETAIL A
SC:10:1

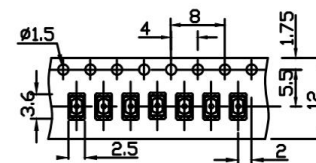

SC 1:10

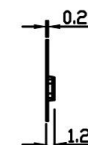

编带的透明带剥离强度标准: 30~100gf

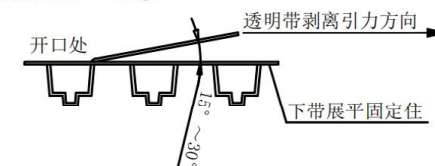

1. RATING: DC 12V, 50mA Max
2. OPERATING FORCE: 200 ± 40 gf
3. TRAVEL: 0.15 ± 0.1 mm
4. LIFE: 300,000 cycles
5. PACKAGE: 10000 Pcs/Reel

6				
5	COVER	1	PI	BLACK
4	KNOB	1	PI	BLACK
3	CONTACT	2	SUS	Ag-Plate
2	TERMINAL	2	PHOSPHOR BRONZE	Ag-Plate
1	CASE	1	LCP	BLACK
ITEM	PART NAME	Q'TY	MATERIAL	FINISH

8				
7				
6				
5				
4	CONTACT	SUS	1	Ag CLAD
3	CASE	PPA/BRASS SRTIP	1	BLACK/Ag PLATED
2	COVER	STEEL STRIP	1	Ni PLATED
1	KNOB	PPA	1	BLACK
NO.	PARTS	MATERIALS	Q'TY	FINISH

TOLERANCE UNLESS SPECIFIED				
WITHIN 1.5mm	: ±0.1mm	A	2012-9-25	初版
OVER 1.5mm	: ±0.2mm	ISSUE	DATE	DESCRIPTIONS OF REVISION
TITLE : Tact Switch		UNIT : mm	DRWG NO.: XB-TS-2819F	
MODEL: XB-TS-2819F		SCALE: 5:1	DWN.	JUN. YANG 2012-9-25
东莞市溪榜电子有限公司		CHK'D	DONG. PANG 2012-9-25	
DONG GUAN XI BANG ELECTRONICS CO., LTD.		APPD.	ZENQ. CHEN 2012-9-25	