

CAD FILE:

**ROHS**

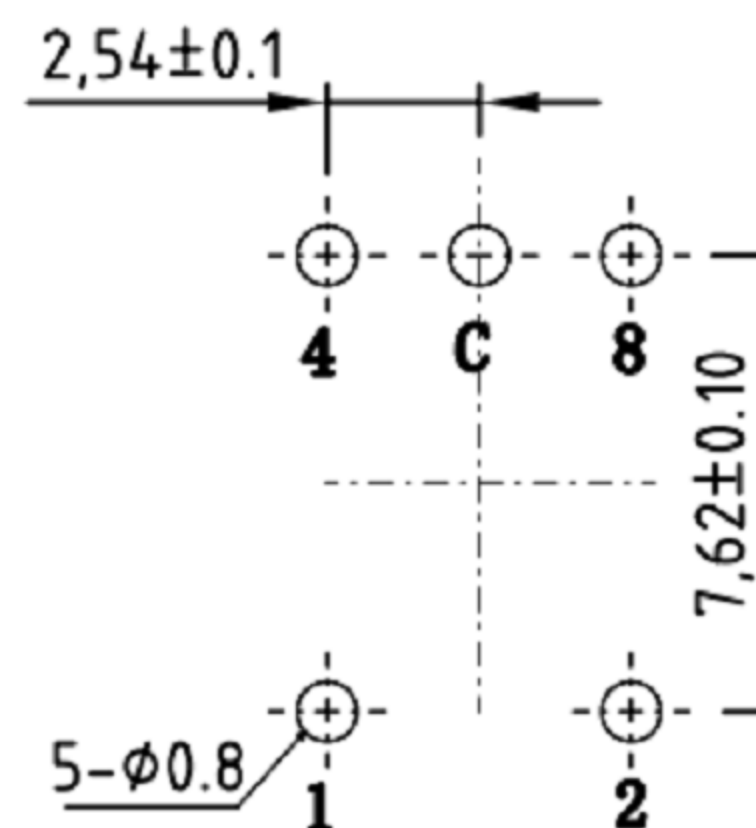
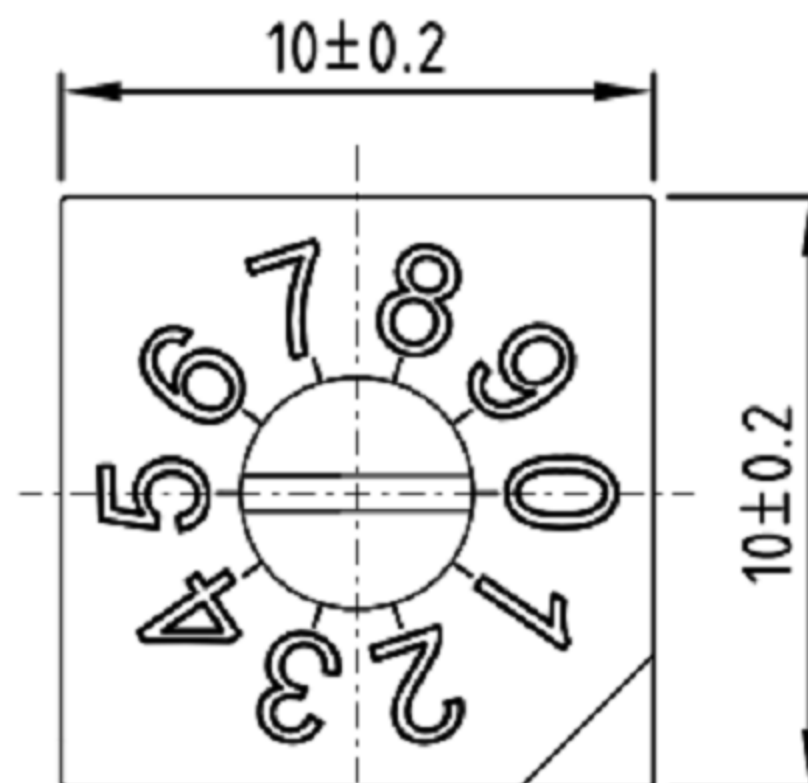
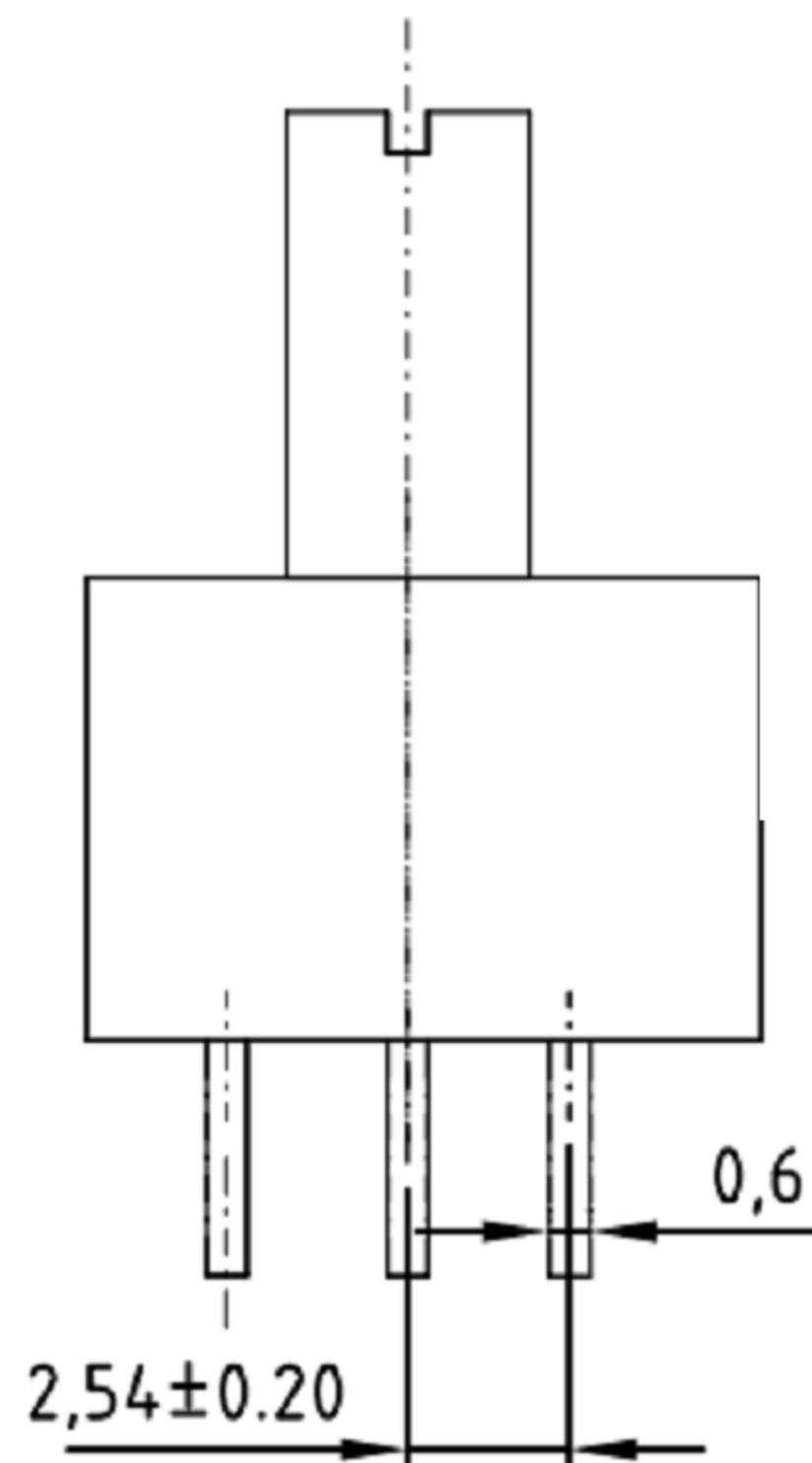
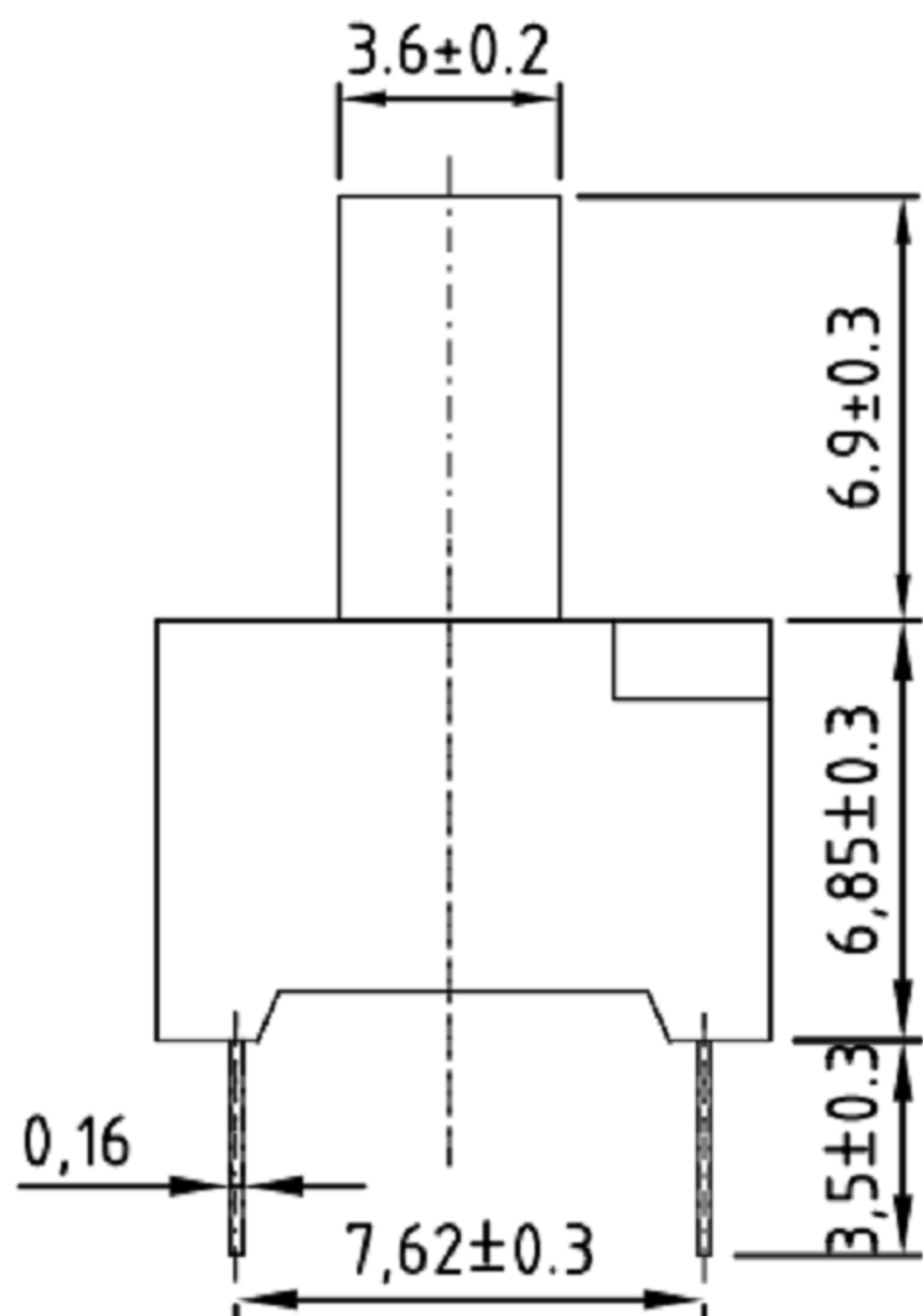

**1 ELECTRICAL**

Contact rating	25mA, 24 VDC
switching	100mA, 50 VDC
non-switching	100mA Max
Contact resistance	1000mΩ Min.at 100 VDC
Insulation resistance	250VAC Min.for 60 seconds
Dielectric strength	

**2 MECHANICAL AND ENVIRONMENTAL**

Temperature rating	-10°C to +70°C
operating	-25°C to +85°C
storage	500gf-cm Max
Operation force	2000 steps per position
Mechanical life	10Hz-50Hz-10Hz for 6 Hrs.
Vibration	

**3 OUTPUT CODES**

PIN NO	POSITION									
	0	1	2	3	4	5	6	7	8	9
1		●		●		●		●		●
2			●	●			●	●		
4					●	●	●	●		
8									●	●

NO.	PARTS	MATERIALS	Q'TY	FINISH	TOLERANCE UNLESS SPECIFIED	ISSUE	DATE	DESCRIPTIONS OF REVISION	APPD.
8									
7									
6					WITHIN 1.5mm : ±0.1mm	A	2012-9-25	初版	ZENQ. CHEN
5					OVER 1.5mm : ±0.2mm	ISSUE	DATE	DESCRIPTIONS OF REVISION	APPD.
4	CONTACT	SUS	1	Ag CLAD	TITLE : Encoder Swith			UNIT : mm	DRWG NO.: XB-rsl10
3	CASE	PPA/BRASS SRTIP	1	BLACK/Ag PLATED	MODEL:			SCALE: 5:1	DWN. JUN. YANG 2012-9-25
2	COVER	STEEL STRIP	1	Ni PLATED	<b>东莞市溪榜电子有限公司</b> DONG GUAN XI BANG ELECTRONICS CO., LTD.			CHK'D	DONG. PANG 2012-9-25
1	KNOB	PPA	1	BLACK				APPD.	ZENQ. CHEN 2012-9-25