

安装孔尺寸

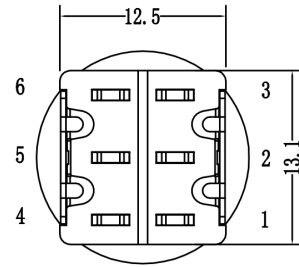
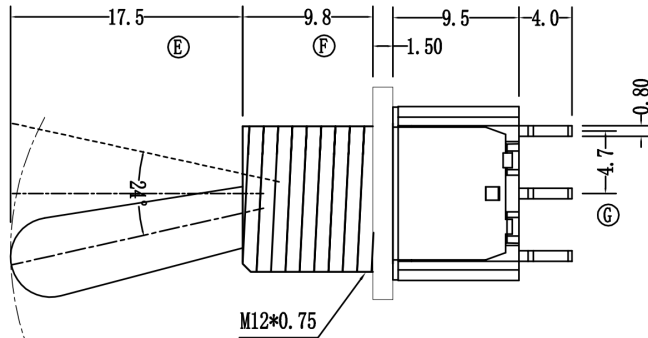
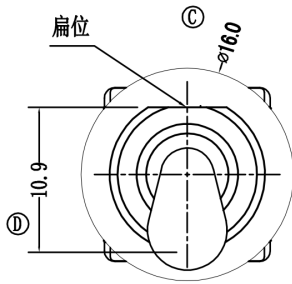

标注: ①-③为重点检测尺寸

手柄位置及导通端子示意图

	POS. 1	POS. 2	POS. 3
Model NO.			
234	ON	ON	ON
SCHEMATIC			

Technical characteristics

SPECIFICATION: 5 A max. @ 125 VAC.
 2 A max. @ 250 VAC.
 MECHANICAL LIFE: 40,000 make-and-break cycles.
 CONTACT RESISTANCE: 20mΩ max. initial @2-4VDC
 100mA for both silver.
 INSULATION RESISTANCE: 1000 MΩ min.
 DIELECTRIC STRENGTH: 1500 VAC min.
 OPERATING TEMPERATURE: -30°C to +85°C.

Materials

CASE: PPA (UL 94V-0)
 HOUSING: Stainless Steel.
 ACTUATOR: Alloy, chrome plated.
 BUSHING: Alloy, nickel plated.
 CONTACT/TERMINALS: Copper alloy silver plated.
 RoHS



公差 TOLERANCES		.X ± 0.4 .XX ± 0.25		角度 ± 5°		UNIT 单位 mm	SCALE 1:1	
版本 VERSION	AO	比例尺 SCALE	NONE	日期 DATE	2022. 6. 29	TITLE 图名	TOGGLE SWITCH	
核准		核对		绘图	WSL	DWG NO. 料号		
版本 VER.	变更说明 CHANGE DESCRIPTION	日期 DATE	ECN NO.	核准 APPROVED BY	核对 CHECKED BY	绘图 DRAWN BY	PART NO. 型号	MT-0-233-L001-Y100-RS