

电路图 (Circuitry)

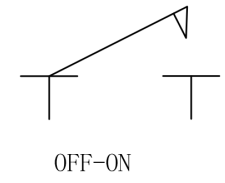

安装尺寸 (Mounting)

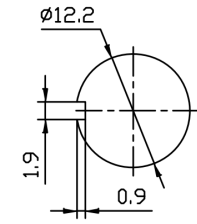

注: ①-⑦ 为重点检验尺寸.

Technical characteristics

SPECIFICATION: 15 A max. @ 125 VAC.
 10 A max. @ 250 VAC.
 MECHANICAL LIFE: 40,000 make-and-break cycles.
 CONTACT RESISTANCE: 50mΩ max. initial @2-4VDC
 100mA for both silver.
 INSULATION RESISTANCE: 1000 MΩ min.
 DIELECTRIC STRENGTH: 1500 VAC min.
 OPERATING TEMPERATURE: -30°C to +85°C.

Materials

CASE: PF (UL 94V-0)
 HOUSING: SPCC.
 ACTUATOR: Alloy, nickel plated.
 BUSHING: Alloy, nickel plated.
 CONTACT/TERMINALS: Copper alloy silver plated.
 RoHS

此图纸仅供参考, 实际尺寸以实物为准!



		公差 TOLERANCES		.X±0.6	.XX±0.4	角度	±5°	UNIT 单位	mm	SCALE 1:1	
		版本	A0	比例尺	NONE	日期	2022. 5. 18	TITLE 图名	TOGGLE SWITCH		
		变更说明	核 准	SCALE		DATE		DWG NO. 料号			
版本 VER.	变更说明	CHANGE DESCRIPTION	日期 DATE	ECN NO.	核 对	核 对	绘 图	PART NO. 型号	KN3 (C)-101-AP-M-RS		
				APPROVED BY	CHECKED BY	DRAWN BY	WSL				