

SECTION A-A

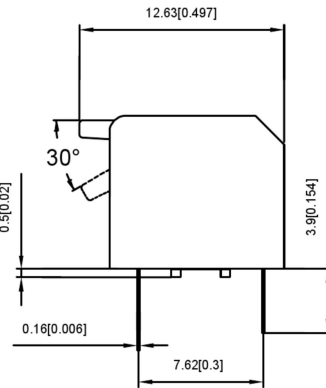

Projection (P)

CIRCUIT

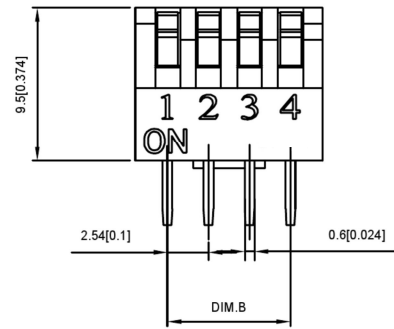
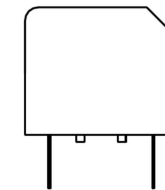
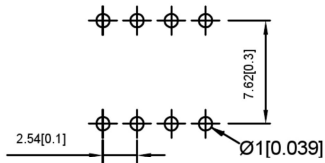
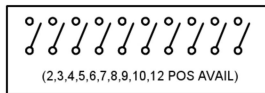

Short (S)

| PART NO. | NO.OF POS | DIM.A | DIM.B | Cover/Red(R) |          | Cover/Blue(BL) |           |
|----------|-----------|-------|-------|--------------|----------|----------------|-----------|
|          |           |       |       | Projedion(P) | Short(S) | Projedion(P)   | Short(S)  |
| DPL-01   | 1         | 3.98  |       | DPL-01RP     | DPL-01RS | DPL-01BLP      | DPL-01BLS |
| DPL-02   | 2         | 6.52  | 2.54  | DPL-02RP     | DA-02RS  | DPL-02BLP      | DPL-02BLS |
| DPL-03   | 3         | 9.06  | 5.08  | DPL-03RP     | DA-03RS  | DPL-03BLP      | DPL-03BLS |
| DPL-04   | 4         | 11.6  | 7.62  | DPL-04RP     | DA-04RS  | DPL-04BLP      | DPL-04BLS |
| DPL-05   | 5         | 14.14 | 10.16 | DPL-05RP     | DA-05RS  | DPL-05BLP      | DPL-05BLS |
| DPL-06   | 6         | 16.68 | 12.7  | DPL-06RP     | DA-06RS  | DPL-06BLP      | DPL-06BLS |
| DPL-07   | 7         | 19.22 | 15.24 | DPL-07RP     | DA-07RS  | DPL-07BLP      | DPL-07BLS |
| DPL-08   | 8         | 21.76 | 17.78 | DPL-08RP     | DA-08RS  | DPL-08BLP      | DPL-08BLS |
| DPL-09   | 9         | 24.3  | 20.32 | DPL-09RP     | DA-09RS  | DPL-09BLP      | DPL-09BLS |
| DPL-10   | 10        | 26.84 | 22.86 | DPL-10RP     | DA-10RS  | DPL-10BLP      | DPL-10BLS |
| DPL-12   | 12        | 31.92 | 27.94 | DPL-12RP     | DA-12RS  | DPL-12BLP      | DPL-12BLS |

SPECIFICATION

Contact Rating: 25mA,24V DC  
 Contact Resistance: 50MΩ max  
 Insulation Resistance: 100MΩ min.500V DC  
 Dielectric Strength: 500V AC/1minute  
 Operating Force: 1000gf max  
 Travel: 2mm  
 Operating Life: 3000cycles  
 Operating Temp: -20 °C~+70 °C  
 Storage Temp: -30 °C~+80 °C

| ITEM | PAPT NAMF | QTY | MATERIAL     | FINISHING                                 |
|------|-----------|-----|--------------|---|
| 4    | Terminal  |     | Copper Alloy | T: Tin plated<br>G: Plating<br>Gold≥15MIU |
| 3    | Base      | 1   | Pa66         | Black                                     |
| 2    | Keystake  | 1   | Pa66         | White                                     |
| 1    | Cover     | 1   | Pa66         | Black Blue Red                            |

| DATE | REVISED | APPROVED | UNSPECIFIED TOLERANCES |
|------|---------|----------|------------------------|
|      |         |          |                        |



|      |             |                           |
|------|-------------|---------------------------|
| DSND | SCALE: N/A  | MODEL TYPE:<br>DIP SWITCH |
| DWN  | VIEW:       | PART NO.:<br>DPL-XX-X-X   |
| CHKD | UNIT: mm/in | DWG NO.:                  |
| APPD | SIZE: A4    |                           |